

PUBLICATION REVISION

PUBLICATION NUMBER: 6881029B90-A

PMR NUMBER: 929B90-A1

TITLE: Product Family 56A Pager Programming Guide

Information in the publication listed above has changed since the manual was printed. Use this document to update your manual.

Number of Instruction Pages: 1

Number of Replacement Pages: 6

Revision Summary

Revision Level or PMR Number	Date	Description
6881029B90-A	September, 1997	Current issue
929B90-A1	June 07, 1999	Technical and editorial changes

PMR Number: 929B90-A1

Location	Update Instructions	Purpose
Cover	Remove and replace with new cover page	Name correction
Pages 1/2	Remove and replace with new pages 1/2	Update equipment requirements
Pages 19/20	Remove and replace with new pages 19/20	Field description changes

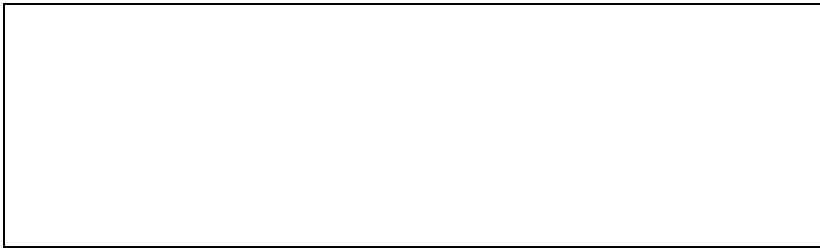

Product Family 56A

Alpha Elite™

PAGER PROGRAMMING GUIDE

SOFTWARE LICENSE AGREEMENT

1. LICENSE GRANT

In connection with the transfer of possession of the software package provided with this Agreement, Unication, (LICENSOR) hereby grants to possessor (LICENSEE) a non-exclusive license to use the software program(s) (SOFTWARE) and documentation (DOCUMENTATION) of said software package with a single-user computer system. LICENSEE may, upon requesting and receiving written permission of LICENSOR, transfer possession of the software package including SOFTWARE and DOCUMENTATION and transfer this license to another party if the other party agrees in writing to accept the terms and conditions of this agreement

2. OWNERSHIP

LICENSEE is given possession of a program module(s) with the software package in or on which Software is copied, but title to the SOFTWARE and DOCUMENTATION, all copies thereof and all rights therein, including all rights in the patents, copyrights, and trade secrets applicable thereto, shall remain vested in LICENSOR, regardless of the form or media in or on which the original and other copies of software and documentation may subsequently exist. Nothing contained herein shall be deemed to convey any title or ownership interest in the program module(s), SOFTWARE or DOCUMENTATION to LICENSEE.

LICENSEE agrees not to disclose, transfer, provide on any form, except as otherwise provided in this agreement, the software package or any portion thereof, to any person other than employees of LICENSEE without prior written consent of LICENSOR, and any such disclosure or transfer shall be consistent with the use in the single-user computer system.

LICENSEE agrees not to reverse compile or disassemble SOFTWARE.

LICENSEE agrees that it will not in any form, export, re-export, resell, ship, or divert or cause to be exported, re-exported, resold, shipped, or diverted, directly or indirectly, the SOFTWARE and DOCUMENTATION or a direct product thereof to any country for which the United States government or any agency thereof at the time of export or re-export requires an export license or other government approval without first obtaining such license or approval.

3. COPYING RIGHTS

LICENSEE may make copy(s) of SOFTWARE and DOCUMENTATION, required for backup or modification purposes in support of the use of the SOFTWARE with the single-user computer system, but LICENSEE must include existing copyright notices on any such copy, modifications, or portion of SOFTWARE merged into another program. Such notice(s) may appear in several forms, including machine-readable form, and LICENSEE agrees to reproduce such notice(s) in each form in which it appears, to the extent it is physically possible to do so.

4. TRANSFERABILITY

LICENSEE may not transfer SOFTWARE and DOCUMENTATION, or any copy(s) thereof, in whole or in part, except as expressly provided in this agreement. If Licensee transfers SOFTWARE and DOCUMENTATION to another party as expressly provided in this agreement, LICENSEE must at the same time either transfer all copies whether printed or machine-readable form to the same party or destroy any copies not transferred; this includes all modifications and portions of SOFTWARE contained or merged into another program.

If LICENSEE transfers SOFTWARE and/or DOCUMENTATION or any copy, modification, or merged portion of SOFTWARE to another party without written permission of LICENSOR, this license is automatically terminated.

5. TERM

The term of this license agreement is for as long as LICENSEE uses the SOFTWARE for its intended purpose. This agreement may be terminated by LICENSEE upon one month's prior written notice. LICENSOR may terminate this agreement if LICENSEE is in default of any of the terms and conditions of this agreement, and termination is effective if LICENSEE fails to correct such default within thirty (30) days after written notice thereof by LICENSOR.

Within one month after termination of this agreement, LICENSEE will certify to LICENSOR in writing that through its best efforts, and to the best of its knowledge, the original and all copies, in whole or in part, in any form, of the SOFTWARE and DOCUMENTATION have been destroyed or returned to LICENSOR.

6. ASSIGNMENT, SUBLICENSE, OR TRANSFER

LICENSEE shall not (by contract, operation of law, or otherwise) assign, sublicense under or transfer this agreement for any right of interest in this agreement, or delegate performance of any of its obligations under this agreement, without the prior written consent of the LICENSOR. Any such assignment, sublicense, transfer, or delegation without the LICENSOR's prior written consent shall be voidable at the LICENSOR's option.

7. WARRANTY AND MAINTENANCE

LICENSOR warrants that under normal use, SOFTWARE shall perform the functions specified in its DOCUMENTATION. If SOFTWARE does not conform to its DOCUMENTATION such that its functional performance is significantly affected and LICENSOR is notified promptly, in writing, within ninety (90) days from the date of shipment of the software package, LICENSOR will correct such nonconformance by repair, or at its option, make available a replacement program module(s) providing there is no misuse of the nonconforming program module(s).

If LICENSOR or its distributor is unable to deliver a replacement module(s) having SOFTWARE which conforms substantially to its DOCUMENTATION, LICENSOR may terminate this license by providing a refund to LICENSEE upon LICENSEE's return of such program modules, except as provided in Section 3 above, any modification in SOFTWARE by LICENSEE or third parties shall void this warranty.

LICENSOR does not represent or warrant that the SOFTWARE or DOCUMENTATION furnished hereunder is free of infringement of any of the third parties, copyrights, trade secrets, or other intellectual property rights.

LICENSOR shall not be responsible for maintenance or field service of the program module(s) and SOFTWARE under this agreement.

THE FOREGOING WARRANTIES ARE EXCLUSIVE AND IN LIEU OF ALL OTHER WARRANTIES WHETHER STATUTORY, EXPRESS OR IMPLIED (INCLUDING ALL WARRANTIES OF MERCHANTABILITY AND FITNESS FOR A PARTICULAR PURPOSE AND ALL WARRANTIES ARISING FROM COURSE OR DEALING OR USAGE OF TRADE) WITH RESPECT TO THE PROGRAM MODULE(S), SOFTWARE, OR DOCUMENTATION FURNISHED BY LICENSOR UNDER THIS AGREEMENT OR ANY USE OF SUCH SOFTWARE OR DOCUMENTATION BY THE LICENSEE.

The remedies provided above are the LICENSEE's exclusive remedies for any failure of LICENSOR to meet its warranty obligations. Actions by LICENSOR in the manner provided above shall constitute complete fulfillment of all the warranty liabilities of LICENSOR whether the claims of the LICENSEE are based on contract, in tort (including negligence and strict liability, or otherwise with respect to or arising out of the program module(s), SOFTWARE or DOCUMENTATION furnished hereunder.

8. LIMITATION OF LIABILITY

LICENSOR, its subcontractors and suppliers of any tier, shall not be liable in contract, in tort (including negligence and strict liability), or otherwise for damages or loss of other property or equipment, loss of profits or revenue, loss of use of equipment or power system, cost of capital, cost of purchased or replacement power or temporary equipment (including additional expenses incurred in using existing facilities), claims of customers of the LICENSEE, or for any special, indirect incidental or consequential damages whatsoever.

The remedies of the LICENSEE set forth herein are exclusive where so stated and the total cumulative liability of the LICENSOR with respect to this agreement, or anything done in connection therewith, whether in contract, in tort (including negligence and strict liability) or otherwise, shall not exceed the price of the product in which such liability is based.

9. NOTICE

All notices in connection with this agreement shall be in writing and shall be given by certified mail, return receipt requested, at the following address: Unication, Inc., 1500 Gateway Blvd., Boynton Beach, FL 33426-8292, ATTENTION: Group Patent Counsel.

10. GOVERNING LAW

This agreement shall be governed and interpreted by the laws of the state of Illinois.

11. AGREEMENT

LICENSEE ACKNOWLEDGES THAT THIS AGREEMENT HAS BEEN READ AND UNDERSTOOD AND AGREES TO BE BOUND BY ITS TERMS AND CONDITIONS. LICENSEE FURTHER AGREES THAT THIS AGREEMENT CONSTITUTES THE ENTIRE UNDERSTANDING OF LICENSEE AND LICENSOR WITH RESPECT TO THE SUBJECT MATTER HEREOF AND COMPLETELY SUPERCEDES ANY PRIOR UNDERSTANDINGS, EITHER ORAL OR WRITTEN. ANY MODIFICATION OF THIS AGREEMENT SHALL BE MADE ONLY BY MUTUAL AGREEMENT AND EVIDENCED BY WRITTEN AMMENDMENT SIGNED BY BOTH LICENSOR AND LICENSEE.

Getting Started

The Product Family 56A (FLEX) PPS and interface package, combined with an IBM® personal computer (or compatible), provides the flexibility to program Product Family 56A pagers to meet individual requirements. To obtain the best results from the product, please take a few minutes to read this instruction guide.

Equipment Required

- **IBM Personal Computer or compatible** (not included)
The Product Family 56A PPS is designed to operate on the IBM personal computer or compatible (386 CPU or higher) with DOS version 3.3 or higher and a serial port. Also, 512K of available RAM is required. If your computer is equipped with a color monitor and a color graphics card, the software runs in color.
- **Programming Interface** (not included)
The Programming Interface provides communication between the computer and the Pager Mechanical Interface. This package includes all cables necessary for connection between the computer, the power source, and the Pager Mechanical Interface.



Use only the latest model of the Programming Interface, NRN8815, with the Product Family 56A (FLEX) pager and pager programming software. Use only the Unication-supplied cable for connection between the Pager Mechanical Interface and the Programming Interface. Use of non-approved cables can result in improper operation and/or incorrect programming of the pager.

- **Pager Mechanical Interface** (included in the Programming kit)
This fixture is designed specifically for the Product Family 56A (FLEX) pager. It allows the pager to be connected to the computer via the Programming Interface. The Pager Mechanical Interface is connected to the Programming Interface with the coiled cable.
- **Pager Programming Software** (included with this manual)
This software program, designed specifically for the Product Family 56A (FLEX) pager, allows you to select the desired information to program into the pager. The 3.5-inch program diskette is provided to facilitate the the installation of the software program.

Getting Started

Equipment Setup

Refer to Figure 1 while performing the following steps.

1. Plug the appropriate connector of the interface cable into the Programming Interface. Connect the other end of the cable to the serial port on your computer.



The program uses COM1 as the default communications port. If both a serial port and a modem are used on the computer, it is recommended that COM1 be used as the serial port. If COM1 cannot be used, change the default to COM2 in the computer configuration screen when installing the software.

2. Plug one end of the coiled cable into the Programming Interface. Plug the other end into the Pager Mechanical Interface.



Use only the Unication-supplied cable for connection between the Programming Interface and the Pager Mechanical Interface. Use of non-approved cables can result in improper operation and/or incorrect programming of the pager.

3. Plug the power supply cable into the Programming Interface and plug the ac/dc adapter into a 120 Vac (or 220 Vac) electrical outlet.

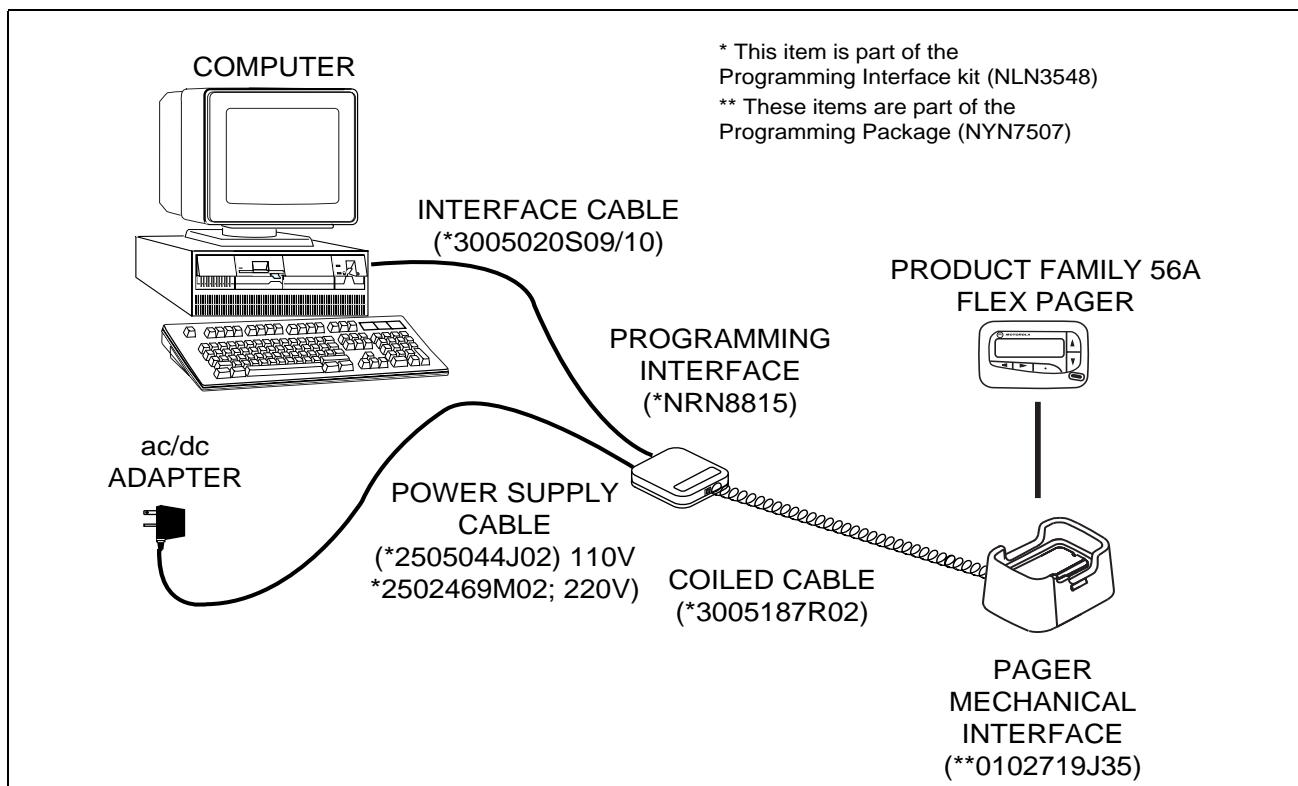

AIPB 942418-C

Figure 1. Equipment Connection Diagram

Field Name	Field Description	Value(s)
Serial No.	<i>Display only.</i> This 10-character field is an identifying number programmed into the pager at the factory. The number displayed should match the one displayed on one of the labels on the pager. If the label is not available, refer to the order form for the appropriate serial number.	(display only)
Inventory Control No.	This field allows you to type a number with up to ten-characters that is stored in the pager. Unlike the serial number, this number can be changed as needed.	(user-defined value)
Operating Mode	This field determines whether the pager has the capability (at the user's discretion) to emit both audible and vibrate alerts (Standard) or only vibrate alerts (Deaf). NOTE: This setting also applies to priority alerts.	Standard Deaf
Frequency	This field designates the frequency of the receiver within the pager.	(determined by valid ranges supported for either crystallized or synthesized receivers)
ADDR 1 ADDR 2 ADDR 3 • • ADDR 16	<i>Display only.</i> Each address is the result of a calculation performed to determine the pager's capcodes. (Additionally, the Decimal Address , Frame , and Battery Cycle values are used for the calculation.) Each even address can contain up to 7-digits. Each odd address can contain up to 9-digits. Up to 2 frames are recommended.	N/A
FLEX Address	<i>Display only.</i> This address value is calculated and displayed when you insert a decimal address.	N/A
Decimal Address (for Addr 1 through 16)	This field is the address on which the pager receives messages. This value is part of the calculation used to determine the capcode. (See the ADDR1 description above). An address can either be long or short. The following rules apply: <ul style="list-style-type: none"> • Address 1 must be enabled (that is, not 0). • Only odd addresses (for example, 3, 5, and so on) can be long. • If an address is long, you cannot define the next address. 	0 (address disabled) Short addresses: 1–1,933,312 2,009,088–2,025,471 Long addresses: 2,101,249–999,999,999
Allow Personal	This field allows you to specify the pager's current address be allowed to receive personal messages that are of address type Individual or Group.	Yes No
Priority (for Addr 1 through 16)	This field allows you to select specific addresses on which to receive priority messages. Priority messages override all other pager activity. All priority messages will alert audibly unless the Operating Mode is set to Deaf (in which case the pager will vibrate). If the priority for this address is set to No , a priority message received on this address will be processed the same as any other message received on this address.	No Yes

Field Name	Field Description	Value(s)
Maildrop History (for Addr 1 through 16)	This field allows you to establish a specific address to have the history option either enabled or disabled. The history option allows the pager to store up to 4 history messages per maildrop.	No Yes
Frame (for Addr 1 through 16)	This value is automatically computed (the "derived frame" value) when an address is typed. If you want to type a different value, a pop-up dialog box is displayed, asking if you want to use the derived value.	(Calculated derived frame value) 0-127
Battery Cycle (for Addr 1 through 16)	This value determines how often the pager searches for its address. NOTE: This field defaults to 4 whenever a new Decimal Address value is typed.	4 0-7
Address Type (for Addr 1 through 16)	This value determines the type of message the pager receives on a specific address.	Individual (one pager receives message) Group (multiple pagers receive same message)
Enable OTA	This field determines whether the pager can receive Over the Air (OTA) pages. Over the Air pages can enable or disable the pager, reset the pager, turn on the receiver, and change code plug data. To access this field, press [F6] . This displays the Password/OTA screen. Change the NO to YES for Enable OTA Programming and type your password. Press [F3] on the Password/OTA screen to come back to this screen. Access to this field is now available.	No Yes
TOTAL Personal Memory	<i>Display only.</i> The values for both this field and the TOTAL Maildrop Memory field are typed when the pager is first programmed. That is the only time values can be typed in either of these fields. This value is the proportion of available RAM designated for use by personal characters versus maildrop characters. Selections are dependent upon the RAM size available (in this pager, 32k). NOTE: The combined total of these two fields should equal 32k. The values in both fields are listed as they would be used (for example, 3k in this field goes with 29k in the TOTAL Maildrop Memory field.	3k 5k 10k 16k 21.5k 27k 32k
TOTAL Maildrop Memory	<i>Display only.</i> The values for both this field and the TOTAL Personal Memory field are typed when the pager is first programmed. That is the only time values can be typed in either of these fields. This value is the proportion of available RAM designated for use by maildrop characters versus personal characters. Selections are dependent upon the RAM size available (in this pager, 32k). NOTE: The combined total of these two fields should equal 32k. The values in both fields are listed as they would be used (for example, 29k in this field goes with 3k in the TOTAL Personal Memory field.	29k 27k 222k 16k 10.5k 5k 0k



MOTOROLA

Product Family 56A FLEX™

Alpha Elite™

Alpha® FLX32

PAGER PROGRAMMING GUIDE

SOFTWARE LICENSE AGREEMENT

1. LICENSE GRANT

In connection with the transfer of possession of the software package provided with this Agreement, Unication, (LICENSOR) hereby grants to possessor (LICENSEE) a non-exclusive license to use the software program(s) (SOFTWARE) and documentation (DOCUMENTATION) of said software package with a single-user computer system. LICENSEE may, upon requesting and receiving written permission of LICENSOR, transfer possession of the software package including SOFTWARE and DOCUMENTATION and transfer this license to another party if the other party agrees in writing to accept the terms and conditions of this agreement

2. OWNERSHIP

LICENSEE is given possession of a program module(s) with the software package in or on which Software is copied, but title to the SOFTWARE and DOCUMENTATION, all copies thereof and all rights therein, including all rights in the patents, copyrights, and trade secrets applicable thereto, shall remain vested in LICENSOR, regardless of the form or media in or on which the original and other copies of software and documentation may subsequently exist. Nothing contained herein shall be deemed to convey any title or ownership interest in the program module(s), SOFTWARE or DOCUMENTATION to LICENSEE.

LICENSEE agrees not to disclose, transfer, provide on any form, except as otherwise provided in this agreement, the software package or any portion thereof, to any person other than employees of LICENSEE without prior written consent of LICENSOR, and any such disclosure or transfer shall be consistent with the use in the single-user computer system.

LICENSEE agrees not to reverse compile or disassemble SOFTWARE.

LICENSEE agrees that it will not in any form, export, re-export, resell, ship, or divert or cause to be exported, re-exported, resold, shipped, or diverted, directly or indirectly, the SOFTWARE and DOCUMENTATION or a direct product thereof to any country for which the United States government or any agency thereof at the time of export or re-export requires an export license or other government approval without first obtaining such license or approval.

3. COPYING RIGHTS

LICENSEE may make copy(s) of SOFTWARE and DOCUMENTATION, required for backup or modification purposes in support of the use of the SOFTWARE with the single-user computer system, but LICENSEE must include existing copyright notices on any such copy, modifications, or portion of SOFTWARE merged into another program. Such notice(s) may appear in several forms, including machine-readable form, and LICENSEE agrees to reproduce such notice(s) in each form in which it appears, to the extent it is physically possible to do so.

4. TRANSFERABILITY

LICENSEE may not transfer SOFTWARE and DOCUMENTATION, or any copy(s) thereof, in whole or in part, except as expressly provided in this agreement. If Licensee transfers SOFTWARE and DOCUMENTATION to another party as expressly provided in this agreement, LICENSEE must at the same time either transfer all copies whether printed or machine-readable form to the same party or destroy any copies not transferred; this includes all modifications and portions of SOFTWARE contained or merged into another program.

If LICENSEE transfers SOFTWARE and/or DOCUMENTATION or any copy, modification, or merged portion of SOFTWARE to another party without written permission of LICENSOR, this license is automatically terminated.

5. TERM

The term of this license agreement is for as long as LICENSEE uses the SOFTWARE for its intended purpose. This agreement may be terminated by LICENSEE upon one month's prior written notice. LICENSOR may terminate this agreement if LICENSEE is in default of any of the terms and conditions of this agreement, and termination is effective if LICENSEE fails to correct such default within thirty (30) days after written notice thereof by LICENSOR.

Within one month after termination of this agreement, LICENSEE will certify to LICENSOR in writing that through its best efforts, and to the best of its knowledge, the original and all copies, in whole or in part, in any form, of the SOFTWARE and DOCUMENTATION have been destroyed or returned to LICENSOR.

6. ASSIGNMENT, SUBLICENSE, OR TRANSFER

LICENSEE shall not (by contract, operation of law, or otherwise) assign, sublicense under or transfer this agreement for any right of interest in this agreement, or delegate performance of any of its obligations under this agreement, without the prior written consent of the LICENSOR. Any such assignment, sublicense, transfer, or delegation without the LICENSOR's prior written consent shall be voidable at the LICENSOR's option.

7. WARRANTY AND MAINTENANCE

LICENSOR warrants that under normal use, SOFTWARE shall perform the functions specified in its DOCUMENTATION. If SOFTWARE does not conform to its DOCUMENTATION such that its functional performance is significantly affected and LICENSOR is notified promptly, in writing, within ninety (90) days from the date of shipment of the software package, LICENSOR will correct such nonconformance by repair, or at its option, make available a replacement program module(s) providing there is no misuse of the nonconforming program module(s).

If LICENSOR or its distributor is unable to deliver a replacement module(s) having SOFTWARE which conforms substantially to its DOCUMENTATION, LICENSOR may terminate this license by providing a refund to LICENSEE upon LICENSEE's return of such program modules, except as provided in Section 3 above, any modification in SOFTWARE by LICENSEE or third parties shall void this warranty.

LICENSOR does not represent or warrant that the SOFTWARE or DOCUMENTATION furnished hereunder is free of infringement of any of the third parties, copyrights, trade secrets, or other intellectual property rights.

LICENSOR shall not be responsible for maintenance or field service of the program module(s) and SOFTWARE under this agreement.

THE FOREGOING WARRANTIES ARE EXCLUSIVE AND IN LIEU OF ALL OTHER WARRANTIES WHETHER STATUTORY, EXPRESS OR IMPLIED (INCLUDING ALL WARRANTIES OF MERCHANTABILITY AND FITNESS FOR A PARTICULAR PURPOSE AND ALL WARRANTIES ARISING FROM COURSE OR DEALING OR USAGE OF TRADE) WITH RESPECT TO THE PROGRAM MODULE(S), SOFTWARE, OR DOCUMENTATION FURNISHED BY LICENSOR UNDER THIS AGREEMENT OR ANY USE OF SUCH SOFTWARE OR DOCUMENTATION BY THE LICENSEE.

The remedies provided above are the LICENSEE's exclusive remedies for any failure of LICENSOR to meet its warranty obligations. Actions by LICENSOR in the manner provided above shall constitute complete fulfillment of all the warranty liabilities of LICENSOR whether the claims of the LICENSEE are based on contract, in tort (including negligence and strict liability, or otherwise with respect to or arising out of the program module(s), SOFTWARE or DOCUMENTATION furnished hereunder.

8. LIMITATION OF LIABILITY

LICENSOR, its subcontractors and suppliers of any tier, shall not be liable in contract, in tort (including negligence and strict liability), or otherwise for damages or loss of other property or equipment, loss of profits or revenue, loss of use of equipment or power system, cost of capital, cost of purchased or replacement power or temporary equipment (including additional expenses incurred in using existing facilities), claims of customers of the LICENSEE, or for any special, indirect incidental or consequential damages whatsoever.

The remedies of the LICENSEE set forth herein are exclusive where so stated and the total cumulative liability of the LICENSOR with respect to this agreement, or anything done in connection therewith, whether in contract, in tort (including negligence and strict liability) or otherwise, shall not exceed the price of the product in which such liability is based.

9. NOTICE

All notices in connection with this agreement shall be in writing and shall be given by certified mail, return receipt requested, at the following address: Unication, Inc., 1500 Gateway Blvd., Boynton Beach, FL 33426-8292, ATTENTION: Group Patent Counsel.

10. GOVERNING LAW

This agreement shall be governed and interpreted by the laws of the state of Illinois.

11. AGREEMENT

LICENSEE ACKNOWLEDGES THAT THIS AGREEMENT HAS BEEN READ AND UNDERSTOOD AND AGREES TO BE BOUND BY ITS TERMS AND CONDITIONS. LICENSEE FURTHER AGREES THAT THIS AGREEMENT CONSTITUTES THE ENTIRE UNDERSTANDING OF LICENSEE AND LICENSOR WITH RESPECT TO THE SUBJECT MATTER HEREOF AND COMPLETELY SUPERCEDES ANY PRIOR UNDERSTANDINGS, EITHER ORAL OR WRITTEN. ANY MODIFICATION OF THIS AGREEMENT SHALL BE MADE ONLY BY MUTUAL AGREEMENT AND EVIDENCED BY WRITTEN AMMENDMENT SIGNED BY BOTH LICENSOR AND LICENSEE.

Computer Software Copyrights

The Unication[®] products described in this manual may include copyrighted Unication computer programs stored in semiconductor memories or other media. Laws in the United States and other countries preserve for Unication, Inc., certain exclusive rights for copyrighted computer programs, including the exclusive right to copy or reproduce in any form the copyrighted computer program. Accordingly, any copyrighted Unication computer programs contained in the Unication products described in this manual may not be copied or reproduced in any manner to the extent allowed by law without the express written permission of Unication, Inc. Furthermore, the purchase of Unication products shall not be deemed to grant either directly or by implication, estoppel, or otherwise, any license under the copyrights, patents or patent applications of Unication, Inc., except for the normal, non-exclusive, royalty-free license to use that arises by operation of law in the sale of a product.

Contents

Contents

Getting Started	1
Equipment Required	1
Equipment Setup	2
Installing the Software	4
Starting the Software	7
Using Your PPS	8
Basic Overview For Programming a Pager	8
Main Menu	9
Service Menu	11
Receiver Kits	13
Adjust Hardware Tuned	14
Test Mode	15
Code Options (Single)	18
Code Options (Sequential)	22
Prompts	23
More Prompts	26
Alert Screen	28
Password/OTA Programming Options	32
Features Options	35
More Features	40
Program Menu	43
Save Menu	44
Print Menu	45
Setup Menu	46
Comm Setup Options	47
Color Options	49
Technical Description	50
Maintenance Information	50
Parts Replacement	51
Exploded View Diagram and Parts List	51
Exploded View Diagram and Parts List	52
Troubleshooting Guide	53
Glossary	54
Appendix - Alphanumeric Prompts and Characters.	A-1

Scope of this Manual

This manual contains the following sections:

- **Getting Started**—contains information about equipment requirements, hardware and software installation, and how to start the Product Family 56A Programming Pager Software (PPS) after installation.
- **Using Your PPS**—contains the screens used to read and program a pager or pagers.
- **Technical Description**—provides a technical description of the Pager Mechanical Interface.
- **Troubleshooting Guide**—provides possible solutions to problems encountered during installation or programming of a pager.
- **Glossary**—provides a glossary of technical terms associated with a PPS.

Product names are subject to change without notice. Some product names are available only in certain markets.

Information Presentation

This manual presents different types of information in different ways:

- Information you need to type is printed in **boldface type**.
- Default values are shown *like this*.
- When information from the screen is referred to in the text, it looks like **this**.
- When you need to press a key on the keyboard, the key is represented graphically. For example, instead of “Press the Enter Key,” you will see “Press .

Special characters are used to emphasize certain conditions.

Note: Emphasizes additional information pertinent to the subject matter.



Caution: Emphasizes information about actions which may result in equipment damage.



Warning: Emphasizes information about actions which may result in personal injury.

Field Description Information

Any screen that contains fields is followed by a table of field descriptions. These tables are divided into the following columns.

1. **Field Name**—shown exactly the way it appears on the screen.
2. **Description**—a complete description of what the field is for, how you can use it, what the valid entries are, and how a specific entry in this field can affect the status of another field.
3. **Value(s)**—lists all the available values and where applicable, the *default*. Where no value exists, N/A (not applicable) is shown.

Scope of this Manual

Getting Started

The Product Family 56A (FLEX) PPS and interface package, combined with an IBM® personal computer (or compatible), provides the flexibility to program Product Family 56A pagers to meet individual requirements. To obtain the best results from the product, please take a few minutes to read this instruction guide.

Equipment Required

- **IBM Personal Computer or compatible** (not included)
The Product Family 56A PPS is designed to operate on the IBM personal computer or compatible with DOS version 3.3 or higher and a serial port. Also, 512K of available RAM is required. If your computer is equipped with a color monitor and a color graphics card, the software runs in color.
- **Programming Interface** (not included)
The Programming Interface provides communication between the computer and the Pager Mechanical Interface. This package includes all cables necessary for connection between the computer, the power source, and the Pager Mechanical Interface.



Use only the latest model of the Programming Interface, NRN8815, with the Product Family 56A (FLEX) pager and pager programming software. Use only the Unication-supplied cable for connection between the Pager Mechanical Interface and the Programming Interface. Use of non-approved cables can result in improper operation and/or incorrect programming of the pager.

- **Pager Mechanical Interface** (included in the Programming kit)
This fixture is designed specifically for the Product Family 56A (FLEX) pager. It allows the pager to be connected to the computer via the Programming Interface. The Pager Mechanical Interface is connected to the Programming Interface with the coiled cable.
- **Pager Programming Software** (included with this manual)
This software program, designed specifically for the Product Family 56A (FLEX) pager, allows you to select the desired information to program into the pager. The 3.5-inch program diskette is provided to facilitate the the installation of the software program.

Getting Started

Equipment Setup

Refer to Figure 1 while performing the following steps.

1. Plug the appropriate connector of the interface cable into the Programming Interface. Connect the other end of the cable to the serial port on your computer.



The program uses COM1 as the default communications port. If both a serial port and a modem are used on the computer, it is recommended that COM1 be used as the serial port. If COM1 cannot be used, change the default to COM2 in the computer configuration screen when installing the software.

2. Plug one end of the coiled cable into the Programming Interface. Plug the other end into the Pager Mechanical Interface.



Use only the Unication-supplied cable for connection between the Programming Interface and the Pager Mechanical Interface. Use of non-approved cables can result in improper operation and/or incorrect programming of the pager.

3. Plug the power supply cable into the Programming Interface and plug the ac/dc adapter into a 120 Vac (or 220 Vac) electrical outlet.

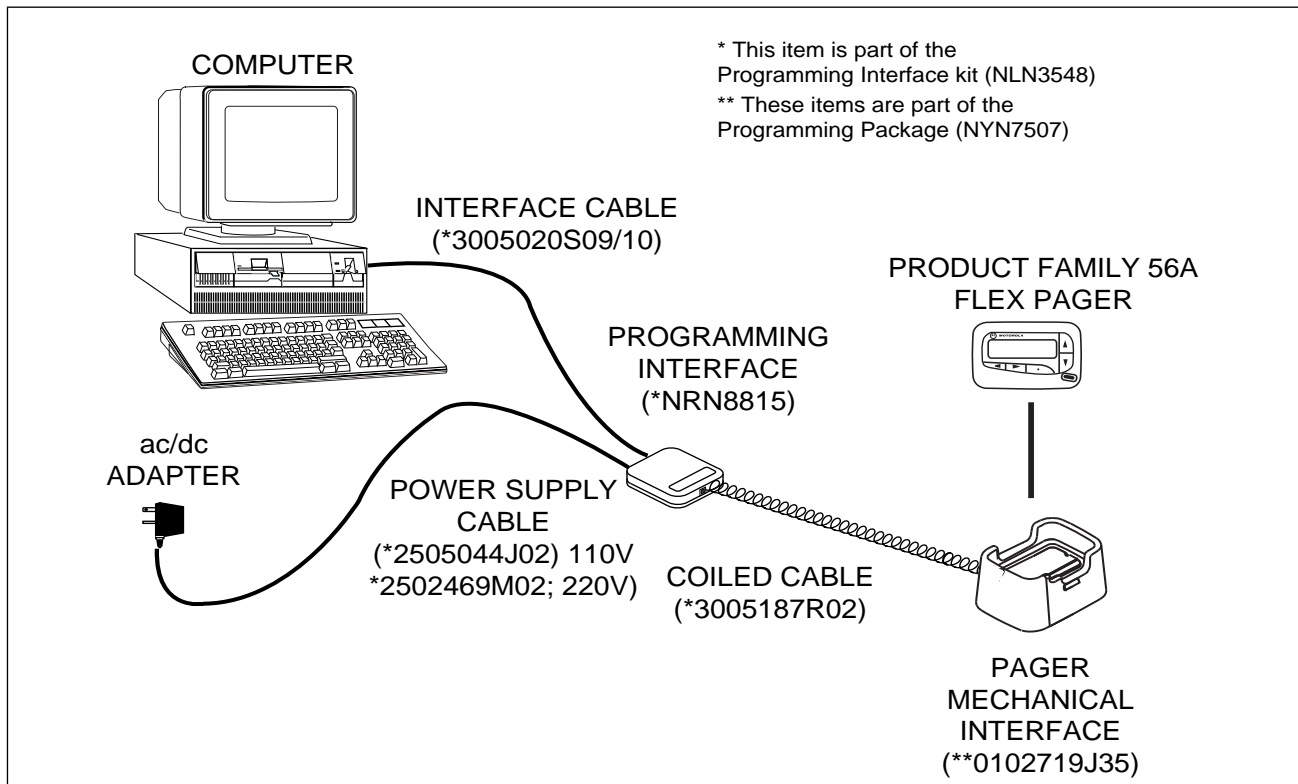

AIPB 942418-C

Figure 1. Equipment Connection Diagram

Personal Computer Configuration

View the CONFIG.SYS file for the following statements and minimum values:

BUFFERS = 20

FILES = 35

Edit the CONFIG.SYS file if necessary.

Preparing a Pager for Reading or Programming

1. Turn the pager on.
2. Remove the Pager Mechanical Interface insert (refer to “Exploded View Diagram and Parts List” on page 52) by prying it out with the flat-tip of a screwdriver.
3. Align the pager contact pin holes with the contact pins of the Pager Mechanical Interface. A red light illuminates on the Programming Interface to indicate proper contact.
4. Close the fixture latch to secure the pager. The pager is now ready to read or program.

Getting Started

Installing the Software

Your Product Family 56A pager programming software diskette includes the file SETUP.EXE. This file automates installation of the software onto a hard disk.

1. Close all application programs that are running on your computer. If you are using Microsoft® Windows, exit Windows to the DOS prompt.
2. Place the Product Family 56A pager programming software diskette into your A: drive.
3. At the DOS prompt, type **A:** and press **Enter**. (Drive B: may also be used if your computer is so equipped.)
4. Type **SETUP** and press **Enter**. A copyright and software version-number screen displays with the instruction **Press any key to Continue**.
5. Press any key; the following screen displays:

UNIFICATION Pager Programming Software PRODUCT FAMILY 56A - ALPHA ELITE Setup Program	
If you would like to make a backup of your PF56A(FLEX) diskette at this time, please follow these steps:	
1.Exit this program. 2.Make a backup copy of your PF56A(FLEX) diskette using DISKCOPY. 3.Rerun SETUP.	
Press the ESCAPE key if you need to make a backup copy of your diskette.	
Press the ENTER key if you are ready to continue the installation.	

➡ Press **Esc** at any time to exit the program and return to the DOS prompt.

Installation Parameters

The following steps and screens help determine the drive and path where the software program is installed.

After you have pressed **Enter** to continue the installation, the following screen displays:

UNICATION Pager Programming Software PRODUCT FAMILY 56A - ALPHA ELITE Setup Program	Enter Drive character.
<p>The Motorola SETUP will install the PF56A (FLEX) Programming Software on your system by creating the necessary directory on your Destination drive and copying the program file and the help file from the Motorola Source drive to your Destination drive. If at any point you want to exit the Setup Program, you can do so by pressing the ESCAPE key.</p>	
Motorola Source Drive	A (For reference only)
Your Destination Drive	C
PPS.EXE Program Path	C:\PF56AFLX
Archive Files Path	C:\PF56AFLX\ARC
Com Port	COM1:
Printer Port	PRN1:
PF56A (FLEX) SW Password	(Leave blank for none)
F10 - Done ESCAPE - Abort	

1. Change the displayed information as applicable. Use **Tab** , **↑** and **↓** , or press **Enter** to move to the fields that can be changed.
2. Press **F10** when satisfied with the information and to continue the installation.

The Product Family 56A (FLEX) software password, if entered in the PF56A (FLEX) SW Password field above, prevents unauthorized users from running your program. If no password is required, leave this field blank.

➡ Press **Esc** at any time to exit the setup program and return to the DOS prompt.

The following table provides an explanation for each field displayed on the Setup Program screen.

Field Name	Description	Value(s)/Results
Unication Source Drive	This is the drive where the installation diskette is inserted.	(Value displayed as a result of setup)
Your Destination Drive	This is the drive where you want the software installed. Type the applicable letter.	C (applicable letter)

Getting Started

Field Name	Description	Value(s)/Results
PPS.EXE Program Path	The program path defines the location where the software is to be installed. Type the directory name, for example: PF56AFLX . NOTE: The drive information is based upon the entry in the Your Destination Drive field.	C:\PF56AFLX (any directory)
Archive Files Path	This is the exact location where the pager configuration files will be stored. It is recommended that this be a subdirectory of the directory typed in the PPS.EXE Program Path field above. Type the path name, for example: PF56AFLX\ARC . NOTE: The drive information is based upon the entry in the Your Destination Drive field.	C:\PF56AFLX\ARC (any path)
Com Port	This is the communications port used to connect the computer to the Programming Interface. Press the Spacebar to display available values. NOTE: If both a serial port and a modem are used on the computer, it is recommended that COM1 be used as the serial port. If COM1 cannot be used, change the default to COM2 . If equipped, your computer might also use COM3 and COM4 .	COM 1 COM 2 COM 3 (when available) COM 4 (when available)
Printer Port	This is the printer port used to connect the computer to the printer. Press the Spacebar to display the available values.	PRN 1 PRN 2 COM 1 COM 2 COM 3 (when available) COM 4 (when available)
Software Password	Type a software password to prevent unauthorized use of your program. If no password is required, leave this field blank.	(blank)

Starting the Software

After installing the program on your hard drive, follow these steps:

1. Turn on your computer.
2. At the C:\> prompt, change to the drive where the PPS is installed (if it is not in the C: drive).
3. At the drive prompt, type **cd PF56AFLX**. The pathname is the directory path where the PF 56A FLEX software is installed.
4. Type **PF56AFLX** and press **Enter**. A brief introductory message is displayed.
5. Press any key to continue.

Software Password

If you selected a password during setup, enter it on the screen shown below and press **Enter**. Use the **← Backspace** and **Del** keys to correct any typing errors while entering the password.

UNICATION Pager Programming Software PRODUCT FAMILY 56A - ALPHA ELITE Software Password;	Enter characters. (A..Z, and 0..9)								
Enter Software Password <div style="background-color: black; width: 100px; height: 15px; margin: 5px auto;"></div>									
F1 HELP	F2	F3	F4	F5	F6	F7	F8	F9	F10 EXIT

➤ *If you type an incorrect password three times, the program ends. If you did not select a password during the installation, this screen does not display.*

Using Your PPS

Basic Overview For Programming a Pager

To read and program a pager, follow these steps:

1. Use the Main menu to initialize the pager for programming.
2. Change default selections using the Options menus.
3. Program the pager with your changes and save the configuration using the Program menus.

These steps are shown graphically below:

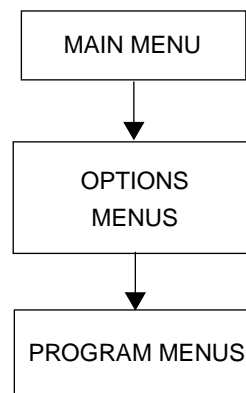

Getting Help

The **F1** key is used for help. Screen help is available whenever you see **F1 Help** in the lower left-hand corner of the screen. Help is also available on each selectable field on a screen by pressing **F1** when the field is highlighted.

On the Help screen, press **PgDn** to see the next page of Help, if available. Press **PgUp** to see a previous page of Help. All menus in this program use **F1** for help.

Main Menu

The Main menu displays all of the programming options (represented by function keys) available in this software. For more information about the options, refer to the table below.

UNIFICATION Pager Programming Software PRODUCT FAMILY 56A - ALPHA ELITE		Select key F1 - F10							
Main;									
<p>F1 - HELP F2 - SERVICE F3 - READ a pager (Pager must be ON and inserted in interface box) F4 F5 - PROGRAM a single pager F6 - PROGRAM sequential pagers F7 - READ and PROGRAM a pager F8 - RETRIEVE a stored pager configuration from disk F9 - SETUP computer configuration F10 - EXIT pager programming software, return to DOS</p>									
F1	F2	F3	F4	F5	F6	F7	F8	F9	F10
HELP	SERVICE	READ A PAGER		PROGRAM SINGLE	PROGRAM SEQUENTIAL	READ & PROGRAM	RETRIEVE FROM DISK	SETUP	EXIT TO DOS

Function Key	Description
F1	Selecting this key displays screen-level help for this Main menu.
F2	Selecting this key displays the Service menu, from which you can select additional options to test the functionality of the pager. For more specific information about the Service menu, go to "Service Menu" on page 11.
F3	Selecting this key reads the pager configuration and then displays the Code screen with all of the current values displayed. You can continue from here to change any values and, subsequently, to program the pager. For more information about the Code screen, go to "Code Options (Single)" on page 18.
F5	Selecting this key allows you to read and program a single pager. The current pager configuration is read and displayed with its current values upon the Code screen. You can continue forward from this screen to change any values and, subsequently, to program the pager. For more information about the Code screen, go to "Code Options (Single)" on page 18. NOTE: If the pager information has been previously read, the read operation is not performed.

Using Your PPS

Function Key	Description
F6	Selecting this key allows you to read and program multiple pagers in a sequential order with the same or similar configurations. The initial pager configuration is read and displayed with its current values upon the Code screen. You can continue forward from this screen to change any values and, subsequently, to program the pager. After you have programmed the first pager, you can save the configuration or go ahead to program the next pager in the group. Inventory control numbers and appropriate addresses are automatically updated to reflect the next pager in the sequence. For more information about the Code (Sequential) screen, go to "Code Options (Sequential)" on page 22.
F7	Selecting this key allows you to automatically program a single pager after reading it. This option is most often used when software patches have been issued.
F8	Selecting this key allows you to retrieve a stored archive file containing previously saved pager settings. After selecting the file, the program reads the settings in this file into the PPS.
F9	Selecting this key displays the Setup menu. For more information about the Setup menu, go to "Setup Menu" on page 46.
F10	Selecting this key opens a confirmation dialog box. Selecting F10 a second time closes the PPS and returns you to DOS.

Service Menu

The Service menu displays options that allow you to make selections for placing the pager in test modes or operation modes. For more information about these options, see the table below.

UNICATION Pager Programming Software PRODUCT FAMILY 56A - ALPHA ELITE Main:Service;	Select key F1 - F10
F1 - HELP F2 - F3 - ADJUST HARDWARE TUNED VALUES F4 - F5 - TEST MODE F6 - QUICK PAGE F7 - KEEP ONLY GOOD MESSAGES F8 - F9 - SET CHIRP MODE F10 - EXIT to Main	

F1	F2	F3	F4	F5	F6	F7	F8	F9	F10
HELP		HARDWARE TUNED		TEST MODE	QUICK PAGE	KEEP GOOD MSGS		CHIRP MODE	EXIT TO MAIN

Function Key	Description
F1	Selecting this key displays screen-level help for this Main menu.
F2	
F3	Selecting this key displays the Adjust Hardware Tuned screen. This screen allows you to make adjustments to the pager clock and LCD. For more information about this screen, go to "Adjust Hardware Tuned" on page 14. NOTE: When this key is selected, a warning dialog box is displayed. It suggests you should not adjust the values on the Adjust Hardware Tuned screen unless you are properly equipped. You can continue or end this operation.
F4	

Using Your PPS

Function Key	Description
F5	Selecting this key displays the Test Mode screen. This screen allows you (via download) to place the pager into test mode and test some of its functionality, such as the vibrator, turning the alert on and off, and so on. For more information about this screen, go to "Test Mode" on page 15.
F6	Selecting this key places the pager into Quick Page mode which results in resetting the time to 0:00 and the counter to 0000. This counter displays the number of pages received by the pager. While in Quick Page mode, the pager emits a short chirp and increments the counter by one whenever a page is received. Because the counter contains only four digits, it will reset to 0000 after the 10,000th page has been received.
F7	Selecting this key disables the Retain Errored Numeric Msg and Retain Errored Non-Num Msg fields while you are performing the tests on the Test Mode screen.
F8	
F9	Selecting this key sets the pager's audible alert to "chirp" while testing. This prevents longer-lasting alerts while in the test mode.
F10	Selecting this key returns the program to the Main menu. NOTE: You can also press Esc .

Adjust Hardware Tuned

This screen allows you to make adjustments to the pager clock and LCD.

UNIFICATION Pager Programming Software PRODUCT FAMILY 56A - ALPHA ELITE		Use Space Bar to select.
Main:Service:AdjustHardwareTuned;		
Clock Second Adjustment	2	
Text Contrast Adjustment	12	
Icon Contrast Adjustment	3	
F1 HELP	F2 PGM PAGER	F3 F4 F5 F6 F7 F8 F9 F10 EXIT ABORT

Function Key	Description
F1	Selecting this key for a highlighted field displays the help for that field.
F2	Selecting this key programs the pager with any adjustments you have made on this screen.
F10	Selecting this key returns you to the Service menu. <i>NOTE: You can also press Esc.</i>

Field Name	Field Description	Value(s)
Clock Second Adjustment	This field allows you to set the crystal of the pager to adjust for seconds lost (negative values) or gained (positive values) in a 24-hour period.	0 +1, +2, +3, +4, +5, +6, +7, +8, -1, -2, -3, -4, -5, -6, -7, -8
Text Contrast Adjustment	This field determines the display contrast of text area on the pager. The higher the number, the darker the display.	0-15
Icon Contrast Adjustment	This field determines the Icon contrast of text area on the pager. The higher the number, the darker the display.	0-3

Test Mode

The Test Mode screen allows for quick testing of the pager's functions.

UNICATION Pager Programming Software PRODUCT FAMILY 56A - ALPHA ELITE Main:Service:TestMode;	Use ARROW keys to move cursor. Use SPACE key to toggle options.								
Exit Test Mode uP Checksum RAM Test Pattern Display Test Pattern Key Test Vibrator Off Vibrator On Alert Off Alert On Backlight Off Backlight On Receiver Connect Test Send CGROM ID Standby Current Test									
F1 HELP	F2	F3 SEND COMMAND	F4	F5	F6	F7	F8	F9	F10 EXIT

Function Key	Description
F1	Selecting this key when a field is highlighted, displays the individual field help. For more general information about the help provided, go to "Getting Help" on page 8.
F3	Select this key after you have selected a specific test (by highlighting it). The test will then be performed by the PPS on the pager.
F10	Selecting this key returns you to the Service menu. NOTE: You can also press Esc .

➔ After you select a test to run (by highlighting it), you must press **F3** to actually run it. Also, it is very important to always perform either the **Exit Test Mode** or the **Standby Current Test** functions before you exit this screen to clear the pager memory.

Field Name	Description	Value(s)/Results
Exit Test Mode	Executing this option exits the test mode. In the process, the pager memory is cleared and the pager is reset to prevent any malfunction.	Not applicable (N/A)

Using Your PPS

Field Name	Description	Value(s)/Results
uP Checksum	Executing this test calculates the uP checksum. The pager transmits the last byte of the total uP checksum in HEX format.	(pager-generated value)
RAM Test Pattern	Executing this option tests the external RAM. All RAM address lines are exercised.	P (Passed test) F (Failed test)
Display Test Pattern	Executing this test allows you to type the display pattern for testing the LCD display. After pressing [F3] , a small window is displayed, prompting you to type several test patterns. It is recommended that the test pattern length be a factor of 120, with 120 being the maximum. Examples are: 1, 2, 3, 4, 5, 6, 7, 8, 10, 12, 15, 20, 24, 30, 40, 60, and 120. Type the number of bytes (in HEX format) to be downloaded and press [F3] . The pattern is displayed. To exit this test, first type 00 . Then press [F3] .	(small window displayed)
Key Test	Executing this option tests all of the buttons on the pager. Hold down a button and press [F3] . The name of the button (which is one of the values listed in the next column) should be displayed in this field. Repeat this procedure until all of the buttons have been tested.	Function Read Left Right Down Up
Vibrator Off	NOTE: Before running this test, run the Vibrator On test. Executing this test turns the vibrator off after it has been turned on by running the Vibrator On test.	(N/A)
Vibrator On	Executing this test turns the vibrator on and keeps it on until you run the Vibrator Off test.	(N/A)
Alert Off	NOTE: Before running this test, run the Alert On test. Executing this test turns the alert off after it has been turned on by running the Alert On test.	(N/A)
Alert On	Executing this test turns the alert on and keeps it on until you run the Alert Off test.	(N/A)
Backlight Off	NOTE: Before running this test, run the Backlight On test. Executing this test turns the backlight off after it has been turned on by running the Backlight On test.	(N/A)
Backlight On	Executing this test turns the backlight on and keeps it on until you run the Backlight Off test.	(N/A)
Receiver Connect Test	Executing this test allows you to set the values to HI or LOW for each of the possible combinations of four different receiver lines (ACLK, A0, A1, and A2).	Set All Low (all combinations of these 4 lines) EXIT
Send CGROM ID	The result of running this test is the display of two bytes of the CG-ROM ID in ASCII format.	T4 (Traditional Chinese) P3 (Simplified Chinese) FFFF (no CG-ROM present)



Field Name	Description	Value(s)/Results
Standby Current Test	Executing this test momentarily places the pager in Standby mode. This disables the RAM, CG-ROM, Interrupts, L/S coast, and uP slow Wait. The pager will then reset (after 4–5 seconds) because the autocoast supply fails to supply the current required to keep the B++. After this test has finished and the pager has been reset, the Test Mode screen is closed and you are returned to the Service menu.	(N/A)







Using Your PPS

Code Options (Single)

This screen provides fields for typing essential pager code and function information for programming a single pager. The screen allows you to select the configuration you want to use to program the pager.

UNIFICATION Pager Programming Software PRODUCT FAMILY 56A - ALPHA ELITE					Enter characters. PgDn to next menu.				
Main:Code;									
Serial No.					Total Personal Memory	[10K]			
Inventory Control No.	1234567890				Total Maildrop Memory	[22K]			
Operating Mode	Standard				Frequency	930.9000			
	ADDR 1	ADDR 2	ADDR 3	ADDR 4					
FLEX Address	E0037137								
Decimal Address	0037137								
Allow Personal	Yes								
Priority	Yes								
Maildrop History	No								
Address Type	Individual								
Frame	017								
Battery Cycle	4								
Enable OTA	No								
F1 HELP	F2 PROGRAM PAGER	F3 NEXT CODE	F4 PROMPT	F5 ALERT	F6 PASSWD OTA	F7	F8 FEATURES	F9 SET TO DEFAULTS	F10 EXIT

➔ You can use either the  or  keys to move through all of the configuration screens or the function keys as described below to jump to specific screens.

Function Key	Description
	Selecting this key programs the pager with the configuration you have selected.
	Select this key to display the next Code screen which contains information about addresses 5 through 8. NOTE: After displaying the next Code screen, press  to advance to Code screens 3 and 4 which display addresses 9 through 16.
	Select this key to display the Prompts screen. For more information about this screen, see "Prompts" on page 23.
	Select this key to display the Alert screen. For more information about this screen, see "Alert Screen" on page 28.
	Select this key to display the Password/OTA Programming screen. For more information about this screen, see "Password/OTA Programming Options" on page 32.

Function Key	Description
F8	Select this key to display the Features screen. For more information about this screen, see "Features Options" on page 35.
F9	Select this key to reset all fields to their default values. NOTE: This will overwrite any changes you have made without having saved to a configuration file.
F10	Selecting this key returns the program to the Main menu. NOTE: You can also press Esc .

Field Name	Field Description	Value(s)
Serial No.	<i>Display only.</i> This 10-character field is an identifying number programmed into the pager at the factory. The number displayed should match the one displayed on one of the labels on the pager. If the label is not available, refer to the order form for the appropriate serial number.	(display only)
Inventory Control No.	This field allows you to type a number with up to ten-characters that is stored in the pager. Unlike the serial number, this number can be changed as needed.	(user-defined value)
Operating Mode	This field determines whether the pager has the capability (at the user's discretion) to emit both audible and vibrate alerts (Standard) or only vibrate alerts (Deaf). NOTE: This setting also applies to priority alerts.	Standard Deaf
Frequency	This field designates the frequency of the receiver within the pager.	(determined by valid ranges supported for either crystallized or synthesized receivers)
ADDR 1 ADDR 2 ADDR 3 • • ADDR 16	<i>Display only.</i> Each address is the result of a calculation performed to determine the pager's capcodes. (Additionally, the Decimal Address , Frame , and Battery Cycle values are used for the calculation.) Each even address can contain up to 7-digits. Each odd address can contain up to 9-digits. Up to 2 frames are recommended. A frame is the remaining number of the division of a pager capcode by 8.	N/A
FLEX Address	<i>Display only.</i> This address value is calculated and displayed when you insert a decimal address.	N/A

Using Your PPS

Field Name	Field Description	Value(s)
Decimal Address (for Addr 1 through 16)	This field is the address on which the pager receives messages. This value is part of the calculation used to determine the capcode. (See the ADDR1 description above). An address can either be long or short. The following rules apply: <ul style="list-style-type: none"> • Address 1 must be enabled (that is, not 0). • Only odd addresses (for example, 3, 5, and so on) can be long. • If an address is long, you cannot define the next address. 	0 (address disabled) Short addresses: 1–1,933,312 2,009,088–2,025,471 Long addresses: 2,101,249–999,999,999
Allow Personal	This field allows you to specify the pager's current address be allowed to receive personal messages that are of address type Individual or Group.	Yes No
Priority (for Addr 1 through 16)	This field allows you to select specific addresses on which to receive priority messages. Priority messages override all other pager activity. All priority messages will alert audibly unless the Operating Mode is set to Deaf (in which case the pager will vibrate). If the priority for this address is set to No , a priority message received on this address will be processed the same as any other message received on this address.	No Yes
Maildrop History (for Addr 1 through 16)	This field allows you to establish a specific address to have the history option either enabled or disabled. The history option allows the pager to store up to 4 history messages per maildrop.	No Yes
Frame (for Addr 1 through 16)	This value is automatically computed (the "derived frame" value) when an address is typed. If you want to type a different value, a pop-up dialog box is displayed, asking if you want to use the derived value.	<i>(Calculated derived frame value)</i> 0–127
Battery Cycle (for Addr 1 through 16)	This value determines how often the pager searches for its address. NOTE: This field defaults to 4 whenever a new Decimal Address value is typed.	4 0–7
Address Type (for Addr 1 through 16)	This value determines the type of message the pager receives on a specific address.	Individual (one pager receives message) Group (multiple pagers receive same message)
Enable OTA	This field determines whether the pager can receive Over the Air (OTA) pages. Over the Air pages can enable or disable the pager, reset the pager, turn on the receiver, and change code plug data. To access this field, press [F6] . This displays the Password/OTA screen. Change the NO to YES for Enable OTA Programming and type your password. Press [F3] on the Password/OTA screen to come back to this screen. Access to this field is now available.	No Yes



Field Name	Field Description	Value(s)
<p>TOTAL Personal Memory</p>	<p><i>Display only.</i> The values for both this field and the TOTAL Maildrop Memory field are typed when the pager is first programmed. That is the only time values can be typed in either of these fields. This value is the proportion of available RAM designated for use by personal characters versus maildrop characters. Selections are dependent upon the RAM size available (in this pager, 32k).</p> <p>NOTE: <i>The combined total of these two fields should equal 32k. The values in both fields are listed as they would be used (for example, 3k in this field goes with 29k in the TOTAL Maildrop Memory field.</i></p>	<p>3k 5k 10k 16k 21.5k 27k 32k</p>
<p>TOTAL Maildrop Memory</p>	<p><i>Display only.</i> The values for both this field and the TOTAL Personal Memory field are typed when the pager is first programmed. That is the only time values can be typed in either of these fields. This value is the proportion of available RAM designated for use by maildrop characters versus personal characters. Selections are dependent upon the RAM size available (in this pager, 32k).</p> <p>NOTE: <i>The combined total of these two fields should equal 32k. The values in both fields are listed as they would be used (for example, 29k in this field goes with 3k in the TOTAL Personal Memory field.</i></p>	<p>29k 27k 22k 16k 10.5k 5k 0k</p>

Using Your PPS

Code Options (Sequential)

This screen provides fields for entering essential pager code and function information to program sequential pagers. It allows you to select the configuration you want to use to program pagers sequentially.

UNIFICATION Pager Programming Software PRODUCT FAMILY 56A - ALPHA ELITE		Enter characters. PgDn to next menu. Sequential Programming Mode	
Main :Code ;			
Inventory Control No.	1234567890	Total Personal Memory[10K]
Operating Mode	Standard	Total Maildrop Memory[22K]
		Frequency	930.9000
	ADDR 1	ADDR 2	ADDR 3
FLEX Address	0174Y0037137		ADDR 4
Decimal Address	0037137		
Allow Personal	Yes		
Priority	Yes		
Maildrop History	No		
Address Type	Group		
Frame	017		
Battery Cycle	4		
Enable OTA	No		
F1 HELP	F2 PROGRAM NEXT SEQUENTIALCODE	F3 F4 PROMPT	F5 F6 ALERT PASSWD OTA
		F7	F8 F9 FEATURES SET TO DEFAULTS
			F10 EXIT

➔ You can use either the  or  keys to move through all of the configuration screens or the function keys as described for the Code Options (Single) screen to jump to specific screens. All the fields on the above screen have the same value and are accessed in the manner described for the Code Options (Single) screen.

Prompts

This screen shows the first half of the pager prompts available with the Product Family 56A (FLEX) pager.

▶ *The **Power Up** and other non-Source <n> Prompts will only display on the pager if the setting for the **Function Menu Display** field on the **Features** screen is set to either **Both** or **Prompts**.*

UNIFICATION Pager Programming Software PRODUCT FAMILY 56A - ALPHA ELITE		Use SPACE BAR to select. PgUp & PgDn to other menu. ALT-R to toggle to DEFAULT	
Main:Prompts;			
International Prompt		English	
International Character Set		US	
Power Up	MOTOROLA		
Pager Disable	PAGER DISABLED	Source <11> Prompt	<11>
Source <1> Prompt	<1>	Source <12> Prompt	<12>
Source <2> Prompt	<2>	Source <13> Prompt	<13>
Source <3> Prompt	<3>	Source <14> Prompt	<14>
Source <4> Prompt	<4>	Source <15> Prompt	<15>
Source <5> Prompt	<5>	Source <16> Prompt	<16>
Source <6> Prompt	<6>	Tone Only <1-5>	TONE ONLY
Source <7> Prompt	<7>	Tone Only <6>	TONE ONLY
Source <8> Prompt	<8>	Tone Only <7>	TONE ONLY
Source <9> Prompt	<9>	Tone Only <8>	TONE ONLY
Source <10> Prompt	<10>	Group Prompt	GROUP
F1 HELP	F2 PROGRAM CODE PAGER	F3 MORE PROMPT	F4 ALERT PASSWD OTA
F5 F6 F7	F8 F9 F10	FEATURES SET TO EXIT DEFAULTS	

You can customize each prompt. When customizing, refer to the percentage bar in the Information area on the screen. This is the amount of memory already used by the prompt text. This percentage cannot exceed 100%. If it does, you must shorten one or more of your customized prompts.

▶ *Only uppercase characters are accepted. Pressing **Alt R** resets a highlighted source prompt to its default value.*

Function Key	Description
F2	Selecting this key programs this pager with the prompts you have selected.
F3	Select this key to display the Code screen. For more information about this screen, see "Code Options (Single)" on page 18 or "Code Options (Sequential)" on page 22, depending on whether you are programming a single pager or sequentially.
F4	Select this key to display the next Prompts screen. For more information about this screen, see "More Prompts" on page 26.

Using Your PPS

Function Key	Description
F5	Select this key to display the Alert screen. For more information about this screen, see "Alert Screen" on page 28.
F6	Select this key to display the Password/OTA Programming screen. For more information about this screen, see "Password/OTA Programming Options" on page 32.
F8	Select this key to display the Features screen. For more information about this screen, see "Features Options" on page 35.
F9	Select this key to reset all fields to their default values. NOTE: This will overwrite any changes you have made without having saved to a configuration file.
F10	Selecting this key returns the program to the Main menu. NOTE: You can also press Esc .

Field Name	Field Description	Value(s)
International Prompt	This field displays the language in which the prompts are displayed.	English French LA & C Portuguese LA & C Spanish Traditional Chinese* Simplified Chinese* (*Require CG-ROM)
International Character Set	This field indicates the selected character set to which all alphanumeric function types are remapped. NOTE: The selected value in this field must work with the value in the International Prompt field (for example, Spanish and LA & C Spanish).	US French LA & C Spanish LA & C Portuguese
Power Up	This field indicates the text displayed on the pager when the pager is turned on.	Unication (any user-specified value)
Pager Disable	This field indicates the text displayed on the pager when the pager has been disabled. The pager is disabled when an incorrect download password is entered.	PAGER DISABLED (any user-specified value)
Source <1> Prompt Source <2> Prompt • • • Source <16> Prompt	Each prompt value indicates text that displays at the end of the message received at that address. The only way the source prompt information will be displayed is if the Show Source field in the Alert screen is set to Yes . NOTE: Make sure the total percentage of prompt memory used (as indicated by the percentage bar in the Information area) does not exceed 100%.	<1> through <16> respectively (any user-specified value)

Field Name	Field Description	Value(s)
Tone Only Prompts	This field indicates the text displayed when a tone only message has been received by the pager.	<i>TONE ONLY</i> <1-5> <i>FAX</i> <6> <i>VOICE MAIL</i> <7> <i>EMAIL</i> <8> (any user-specified value)
Group Prompt	This field indicates the text displayed when a message from an unknown source has been received by the pager.	<i>GROUP</i> (any user-specified value)

Using Your PPS

More Prompts

This screen shows the second half of the pager prompts available with the Product Family 56A (FLEX) pager, and is shown with the default settings.

➤ *Each of the prompts on this screen will only display on the pager if the setting for the **Function Menu Display** field on the **Features** screen is set to either **Both** or **Prompts**. Also, because each of the fields on this screen represents the text displayed if this functionality is selected, no field-by-field description is given for these fields.*

UNIFICATION Pager Programming Software PRODUCT FAMILY 56A - ALPHA ELITE				Enter characters. PgUp & PgDn to other menu. ALT-R to toggle to DEFAULT					
Main:MorePrompts;				88.5% (54)					
Private Time	SET PRIVATE TIME	Standard Alert	STANDARD ALERT						
Choose Alert	CHOOSE ALERT	Pleasant Alert	PLEASING ALERT						
Audible Alert	SET AUDIBLE ALERT	Chirping Alert	CHIRPING ALERT						
Silent Alert	SET SILENT ALERT	Chirp/Silent Alert	CHIRP & SILENT ALERT						
Lock Message	LOCK MESSAGE	No Msg Alert	NO MESSAGE ALERT						
Unlock Message	UNLOCK MESSAGE	MailDrop Alert On	MAILDROP ALERT ON						
Delete Message	DELETE MESSAGE	MailDrop Alert Off	MAILDROP ALERT OFF						
Delete All Msgs	DELETE ALL MESSAGES	On	ON						
Set Time/Alarm	SET TIME AND ALARM	Off	OFF						
Set Alarm	SET ALARM	Add to Notebook	ADD TO NOTEBOOK						
Turn Pager Off	TURN PAGER OFF	Print Message	PRINT						
Escape	ESCAPE	Zoom In	ZOOM IN						
Duplicate Msg	DUPLICATE MESSAGE	Zoom Out	ZOOM OUT						
Memory Full	MEMORY FULL	Set Msg Alarm	SET MESSAGE ALARM						
Set Time	SET TIME	Notebook	NOTEBOOK						
F1	F2	F3	F4	F5	F6	F7	F8	F9	F10
HELP	PROGRAM CODE PAGER	PROMPT	ALERT	PASSWD OTA		FEATURES	SET TO DEFAULTS	EXIT	

You can customize each prompt. When customizing, refer to the percentage bar in the Information area on the screen. This is the amount of memory already used by prompt text. This percentage cannot exceed 100%. If it does, you must shorten one or more of your customized prompts.

➤ *Only uppercase characters are accepted. Pressing **Alt R** resets a highlighted source prompt to its default value.*

Function Key	Description
F2	Selecting this key programs this pager with the prompts you have selected.
F3	Select this key to display the Code screen. For more information about this screen, see "Code Options (Single)" on page 18 or "Code Options (Sequential)" on page 22, depending on whether you are programming a single pager or sequentially.

Function Key	Description
F4	Select this key to display the next Prompts screen. For more information about this screen, see "Prompts" on page 23.
F5	Select this key to display the Alert screen. For more information about this screen, see "Alert Screen" on page 28.
F6	Select this key to display the Password/OTA Programming screen. For more information about this screen, see "Password/OTA Programming Options" on page 32.
F8	Select this key to display the Features screen. For more information about this screen, see "Features Options" on page 35.
F9	Select this key to reset all fields to their default values. NOTE: This will overwrite any changes you have made without having saved to a configuration file.
F10	Selecting this key returns the program to the Main menu. NOTE: You can also press Esc .

Using Your PPS

Alert Screen

This screen displays the alert options available with the Product Family 56A (FLEX) pager and is shown with the default option settings.

UNIFICATION Pager Programming Software PRODUCT FAMILY 56A - ALPHA ELITE		Use Space Bar to select. PgUp & PgDn to other menu.	
Main:Alert;			
Disable All Alerts	No	Allow Private Time	Yes
Alert Frequency	3.2 KHz	Vibrator	Yes
Alert Duration	12 sec	Out of Range Time	NONE
User Changeable Alert Mode	Yes	Enable OOR Alert	No
User Selectable Alerts	Yes	OOB Audible On No Alert	No
Programmable Pleasing Alert	Default	Power Up Search Time	4 min
Reminder Alert Interval	2 min	Timeout for Reacq.	40 Min 0 Sec
Reminder Alert Timeout	30 min	Disp. Slot/Msg #	Display Slot #
Manual Alert Reset	No	Show Source	No
Low Battery Alert	No	Function 4 Repeat Period	2 sec
Real Time Clock	Yes	Function 4 Tone Pulse	1/8 sec
Internat'l Date (DD/MM/YY)	No	Key Click	No
Show Time Stamp	Yes	Alarm Always Audible	Yes
Individual Message Alarm	Yes		
Auto Alarm Turn On	Yes		

F1	F2	F3	F4	F5	F6	F7	F8	F9	F10
HELP	PROGRAM CODE PAGER	PROMPT			PASSWD OTA		FEATURES	SET TO DEFAULTS	EXIT

Function Key	Description
F2	Selecting this key programs this pager with the configuration you have selected.
F3	Select this key to display the Code screen. For more information about this screen, see "Code Options (Single)" on page 18 or "Code Options (Sequential)" on page 22, depending upon whether you are programming a single pager or sequentially.
F4	Select this key to display the Prompts screen. For more information about this screen, see "Prompts" on page 23.
F6	Select this key to display the Password/OTA Programming screen. For more information about this screen, see "Password/OTA Programming Options" on page 32.
F8	Select this key to display the Features screen. For more information about this screen, see "Features Options" on page 35.
F9	Select this key to reset all fields to their default values. NOTE: This will overwrite any changes you have made without having saved to a configuration file.
F10	Selecting this key returns the program to the Main menu. NOTE: You can also press Esc .

Field Name	Field Description	Value(s)
Disable All Alerts	This field determines whether all audible and vibrating alerts are disabled. If this field is enabled (Yes), all alert options and configured alert modes do not function.	No Yes
Alert Frequency	This field indicates the frequency to be used for standard alerts.	3.84 kHz 1.24 kHz 3.2 kHz 3.0 kHz 2.5 kHz 2.7 kHz 1.37 kHz
Alert Duration	This field indicates the duration of non-priority pager alerts as either short (2 sec) or long (12 sec). NOTE: If the Low Battery Alert field is set to Yes, the low battery alert will override this setting.	12 sec 2 sec
User Changeable Alert Mode	This field determines whether the user can change the alert mode using the pager's Function menu. If No is selected, the pager is always in the audible mode unless the Operating Mode field on the Code screen is set to Deaf .	Yes No
User Selectable Alerts	This field determines whether the user is able to select either a standard alert, one of the seven pleasing alerts, a chirp alert, or no alert using the CHOOSE ALERTS option in the pager. (This option is accessed using the pager's Function menu.)	Yes No
Programmable Pleasing Alert	This field determines whether you can create custom pleasing alert cadences. If Custom is selected, a special menu displays, allowing you to change the frequency and volume for 16 different notes within each pleasing alert.	Default Custom
Reminder Alert Interval	This field determines the repetitive alert interval time after which the pager generates a chirp sound or vibration until all unread messages are read (unless None is selected which would disable this functionality).	2 min 3.07 min 4 min 5.07 min 10 min 15.07 min 30 min None
Reminder Alert Timeout	The reminder alert timeout (for one or more unread messages) determines how long a reminder alert is emitted if there is no new message received. (After a new message has been received, the time period resets.) After the time period has expired (and until a new message is received), the pager does not emit any more reminder alerts. NOTE: This field is only available if the Reminder Alert Interval field value is set to other than None. Also, this value must be greater than or equal to the one specified in the Reminder Alert Interval field.	None 2 min 3.07 min 4 min 5.07 min 10 min 15.07 min 30 min

Using Your PPS

Field Name	Field Description	Value(s)
Manual Alert Reset	With Yes selected and the pager in the audible mode, an incoming message alert can only be stopped manually by pressing any button on the pager. NOTE: If this field is set to Yes , the Alert Duration field does not apply to individual, group, or priority page alerts.	Yes No
Low Battery Alert	Specifies whether an alert is emitted when a low-battery condition is reached. With this field enabled, a selected 12-second alert duration is reduced to a 2-second alert, and a selected 2-second alert duration is reduced to a 1-second alert when a low battery condition is detected.	Yes No
Real Time Clock	With Yes selected, a real time clock displays the time and date.	Yes No
Internat'l Date (DD/MM/YY)	When Yes is selected, the date is displayed in the international (day-month-year) format.	No Yes
Show Time Stamp	With Yes selected, the pager displays a message's time stamp when it is being read. The time stamp is shown at the very end of the message before the source prompt, if Show Source is enabled.	Yes No
Individual Message Alarm	If Yes is selected, you can attach an alarm to a particular message, with a specified time to initiate the alert.	Yes No
Auto Alarm Turn On	With this field selected and any type of alarm selected, the pager automatically turns on and gives an alarm alert rather than a power-up alert if the pager is off when the alarm expires.	Yes No
Allow Private Time	Allows the pager to use Private Time which is a time period specified by the user when the pager goes into completely silent mode. When activated, the pager continues to receive messages but does not generate any alerts.	Yes No
Vibrator	If Yes is chosen, you can enable the vibrator in the pager. If you change the alert mode to silent and No is selected, the pager does not emit a vibration.	Yes No
Out of Range Time	If a time is selected, pager is "out of range" when it does not detect a FLEX frame for that time period. OOR time must be less than or equal to the parameter set in the Timeout for Reacquisition field. If None is selected, the OOR field is disabled. All times are +/- 10%.	None 4 min 6 min 8 min
Enable OOR Alert	If Yes is chosen, the pager alerts when it is out of range.	No Yes

Field Name	Field Description	Value(s)
OOB Audible On No Alert	This field specifies whether the pager should emit an audible alert when out-of-range and the alert setting on the pager is No Message Alert .	No Yes
Power Up Search Time	This is the maximum time before the system will guarantee that a full FLEX frame will be transmitted.	4 min 1 min
Timeout for Reacq.	Sets the amount of time the pager can miss FLEX frames before it changes to asynchronous. Minutes are entered in the min field and seconds in the sec field.	Any combination of minutes and seconds up to 60 minutes
Disp. Slot/Msg #	Specifies the pager display the message slot number or the message number of personal messages when they are being read. The slot or message number is displayed at the beginning of each message.	Display Slot # Display Msg # Display Neither
Show Source	This field sets the pager to display the text programmed for the associated source at the end of the message.	No Yes
Function 4 Repeat Period	This field allows you to select a 2-second Function 4 repeat time.	2 sec 1 sec
Function 4 Tone Pulse	This field allows you to select a 1/8th second tone pulse.	1/8th sec
Key Click	This field allows you to set the pager so a click sound will occur whenever a pager button is pressed.	No Yes
Alarm Always Audible	This field specifies that the general alarm is either always audible or not audible.	Yes No

Using Your PPS

Password/OTA Programming Options

This screen provides the download password and Over-The-Air options available with the Product Family 56A (FLEX) pager. This screen is shown with the default settings.

UNIFICATION Pager Programming Software PRODUCT FAMILY 56A - ALPHA ELITE		Use SPACE BAR to select. PgUp & PgDn to other menu.
Main:Password/OTA;		
Enable Secure Password	<input type="checkbox"/>	No
Enable Local Password	<input type="checkbox"/>	No
Enable OTA Programming	<input type="checkbox"/>	No
Silent OTA Programming	<input type="checkbox"/>	No
Data Inversion	<input type="checkbox"/>	No

F1	F2	F3	F4	F5	F6	F7	F8	F9	F10
HELP	PROGRAM CODE PAGER	PROMPT	ALERT				FEATURES	SET TO DEFAULTS	EXIT

Function Key	Description
F2	Selecting this key programs this pager with the configuration you have selected.
F3	Select this key to display the Code screen. For more information about this screen, see "Code Options (Single)" on page 18 or "Code Options (Sequential)" on page 22, depending on whether you are programming a single pager or sequentially.
F4	Select this key to display the Prompts screen. For more information about this screen, see "Prompts" on page 23.
F6	Select this key to display the Alert screen. For more information about this screen, see "Alert Screen" on page 28.
F8	Select this key to display the Features screen. For more information about this screen, see "Features Options" on page 35.
F9	Select this key to reset all fields to their default values. NOTE: This will overwrite any changes you have made without having saved to a configuration file.
F10	Selecting this key returns the program to the Main menu. NOTE: You can also press Esc .

Field Name	Description	Value(s)
Enable Secure Password	This field is used to control changes to a pager's frequency and the associated receiver kit number. When activated, the Changing Secure Password screen is immediately displayed. Should the incorrect password be entered eight times, the pager enters the Dead Pager mode.	No Yes
Enable Local Password	This field allows you to provide password protection when reading or writing to the pager's codeplug. When this option is set to Yes , a password is required to read the pager's programmed feature set or program the pager with a new feature set. When activated, the Changing Local Password screen is immediately displayed. Should the incorrect password be entered eight times, the pager enters the Dead Pager mode.	No Yes
Enable OTA Programming	With this option selected, a pager or pagers can be remotely reconfigured. It can be used to change options, enable a temporarily disabled pager or disable a pager, and change codeplug data. The OTA page cannot re-enable a dead (eight attempts with an incorrect password) pager.	No Yes
Silent OTA Programming	With this option selected, the pager powers-up silently after it has been programmed over the air. This field can only be accessed when Enable OTA Programming is set to Yes .	No Yes
Data Inversion		No Yes

Password Levels

To change **Enable Secure Password** from **No** to **Yes**:

1. Press the Spacebar. The **Changing Secure Password** screen is displayed. This screen provides you the opportunity to create and verify a new password.

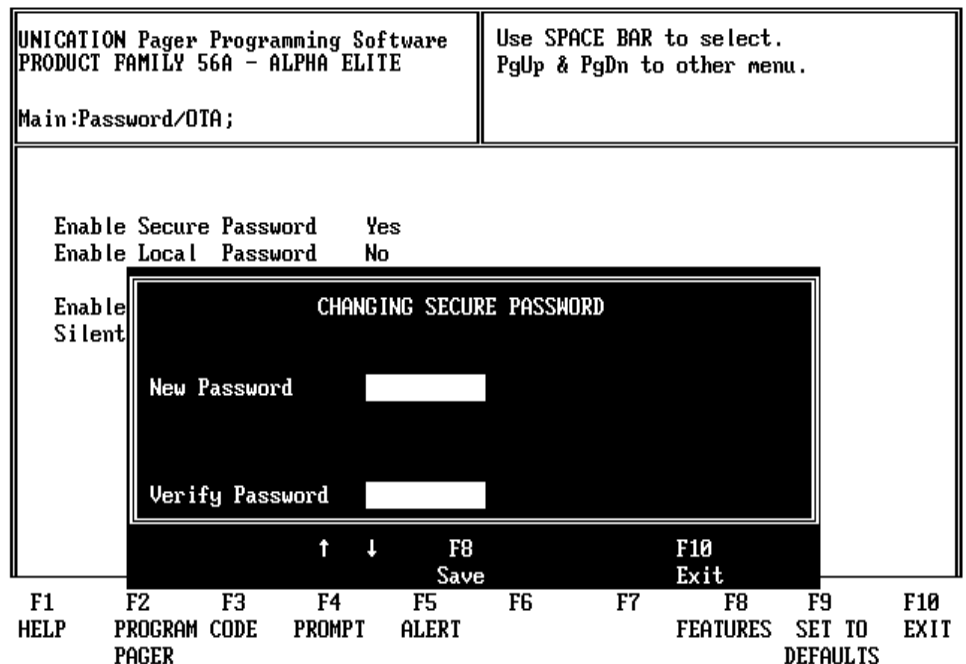

Using Your PPS

Function Key	Description
F8	Selecting this key saves the password.
F10	Selecting this key returns the program to the Password/OTA screen. NOTE: You can also press Esc .

2. Type the new password into the **New Password** field.
3. Press **Enter**.
4. Type the same password into the **Verify Password** field.
5. Press **Enter**.
6. Press **F8** to save the password. When saving the password, you are requested to record your password and press any key to continue.

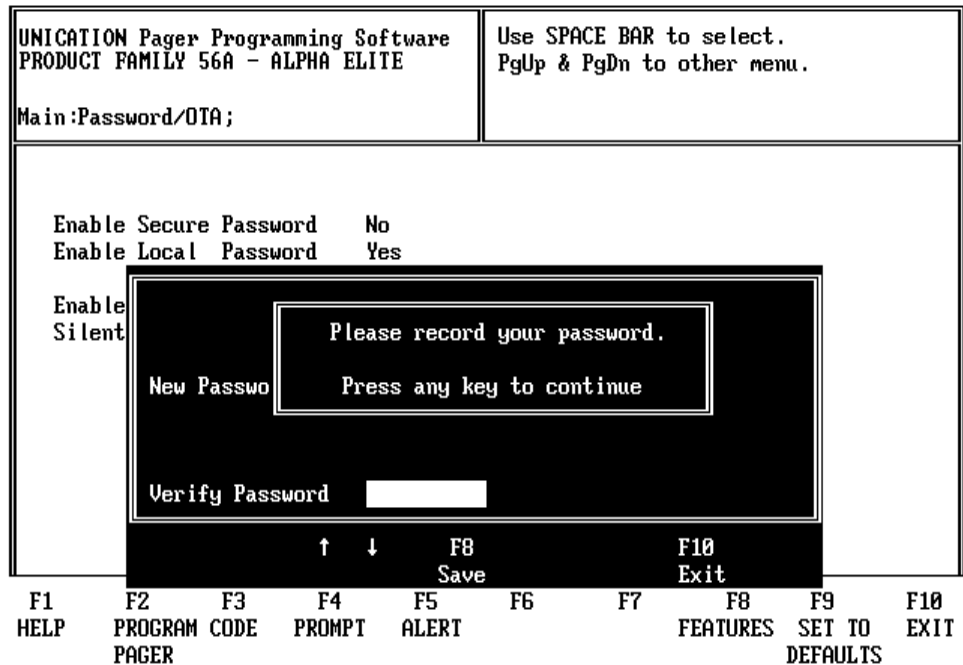

7. Press any key and the **Password/OTA** screen is displayed.

Enabling or changing the passwords for Enable Local Password, Enable OTA Programming, and Silent OTA Programming follows the above procedure.

➡ *If Enable OTA Programming is set to No, Silent OTA Programming is not selectable.*

After a password has been enabled for a function, the program reads the pager while performing that function and prompts for the use of the password before completing the function.

Features Options

This screen shows the first half of the custom selectable options available with the Product Family 56A (FLEX) pager.

UNIFICATION Pager Programming Software PRODUCT FAMILY 56A - ALPHA ELITE		Use Space Bar to select. PgUp & PgDn to other menu.	
Main:Features;			
Retain Errored Numeric Msg	No	Allow Off	Yes
Retain Errored Non-Num Msg	Yes	Function Menu Display	Both
Retain Better MailDrop Msg	Yes	Manual Delete	Yes
Personal Message Notebook	Yes	Message Locking	Yes
MailDrop Message Notebook	Yes	Memory Retention	Yes
Duplicate Message Detection	Yes	Delete All	Yes
Source Indep't Duplication	No		
Sequential Lockout Period	None		
Truncated Message Indicator	No		
Errored Data Indication	Yes		
Two Bit Error Indication	No		
Message Continue Indicator	Yes	Message Preview	Yes
Ignore CR	No	Auto Backlight Disabled	No
Read TimeOut	32 sec	Use Checksum for Errors	Yes
Fast Scroll Time	4 sec	Display Contrast Value	9
F1 HELP	F2 PROGRAM PAGER	F3 CODE	F4 PROMPT
F5 ALERT	F6 PASSWD OTA	F7	F8 MORE FEATURES
			F9 SET TO DEFAULTS
			F10 EXIT

Function Key	Description
F2	Selecting this key programs this pager with the configuration you have selected.
F3	Select this key to display the Code screen. For more information about this screen, see "Code Options (Single)" on page 18 or "Code Options (Sequential)" on page 22, depending on whether you are programming a single pager or sequentially.
F4	Select this key to display the Prompts screen. For more information about this screen, see "Prompts" on page 23.
F5	Select this key to display the Alert screen. For more information about this screen, see "Alert Screen" on page 28.
F6	Select this key to display the OTA Programming screen. For more information about this screen, see "Password/OTA Programming Options" on page 32.
F8	Select this key to display the More Features screen. For more information about this screen, see "More Features" on page 40.
F9	Select this key to reset all fields to their default values. NOTE: This will overwrite any changes you have made without having saved to a configuration file.

Using Your PPS

Function Key	Description
F10	Selecting this key returns the program to the Main menu. <i>NOTE: You can also press Esc.</i>

Field Name	Description	Value(s)
Retain Errored Numeric Msg	If Yes is selected, the pager retains numeric messages that contain errors. If No is selected, the pager discards errored messages.	No Yes
Retain Errored Non-Num Msg	If Yes is selected, the pager retains non-numeric (alphanumeric and ideographic) messages that contain errors. If No is selected, the pager discards errored messages.	No Yes
Retain Better Maildrop Msg	This field allows or disallows the pager to accept a new errored maildrop message and replace an existing maildrop message when: <ul style="list-style-type: none"> - The new message has the same message length as the existing message. - The new message contains the same number of or more good characters than the existing message. 	Yes No
Personal Message Notebook	This field enables the notebook function for personal messages. Messages can be added to and stored within the notebook. When a message is stored in the notebook, it cannot be automatically deleted.	Yes No
Maildrop Message Notebook	This field enables the notebook function for maildrop messages. Messages can be added to and stored within the notebook. When a message is stored in the notebook, it cannot be automatically deleted.	Yes No
Duplicate Message Detection	If Yes is selected, a duplication check is performed on all personal messages with the same function type as the new message, on a character-by-character basis. Errored characters are ignored during the check. If all non-errored characters in both messages match, the existing matching message is flagged as a duplicate. The message with the least number of errors is stored and the other message is discarded. If both messages contain the same number of errors, the new message is discarded and the old message is flagged as a duplicate. When the message is read, the duplicate message prompt appears before the first line of the message.	Yes No
Source Indep't Duplication	This field allows or disallows the pager to perform a duplication check on all personal messages stored in the pager, regardless of the message source.	No Yes

Field Name	Description	Value(s)
Sequential Lockout Period	This field specifies whether the pager ignores duplicate transmissions that occur within the specified time period. When a message arrives, a sequential lockout timer begins and the message is flagged as being sequentially locked out. If a new message arrives and it is a duplicate, one of the messages will be discarded and the message will not be flagged as a duplicate. However, the message will receive a new time stamp.	None, 8 sec 16 sec, 32 sec 64 sec, 96 sec 2 min, 3 min 4 min, and 5 min
Truncated Message Indicator	This field allows or disallows the pager to show a truncated message indicator at the end of a truncated message. A truncated message exceeds the maximum message length or has been truncated because there is not enough available unprotected memory to store the message.	No Yes
Errored Data Indication	This field allows or disallows the pager to display a non-transmittable error character alternately with a single character representation of the errored data.	Yes No
Two Bit Error Indication	This field specifies whether the pager indicates when message code words with 2-bit errors or more are received the errored character flash on the display.	Yes No
Message Continue Indicator	This field allows or disallows the pager to indicate when a message contains more data on the next screen. For both alphanumeric and ideographic modes, a blinking down arrow is displayed in the lower right-hand corner of the pager screen. The blinking alternates every 1/2 second.	Yes No
Ignore CR	This field specifies whether the pager will ignore carriage returns when displaying messages.	No Yes
Read TimeOut	This field specifies the message display screen timeout period. When no inputs are received for the specified time, the pager screen reverts to the Status screen and eventually to the Standby (blank) screen.	16 sec 32 sec 64 sec 5.07 min
Fast Scroll Time	While reading a message in the fast scroll mode, the display advances forward one screen every "fast scroll time" period.	1/2 sec 1 sec 2 sec 3 sec 4 sec 6 sec 8 sec 10 sec 30 sec
Allow Off	This field designates whether the pager can be turned off using the pager's Function menu.	Yes No
Function Menu Display	This field specifies how the pager's Function menu is displayed: <ul style="list-style-type: none"> - prompts only - prompts and icons - icons only 	Both Icons Prompts

Using Your PPS

Field Name	Description	Value(s)
Manual Delete	This field determines whether to allow the pager to delete individual messages.	Yes No
Message Locking	This field indicates whether the pager can lock up to 10 personal messages. A locked message cannot be automatically deleted from the pager.	Yes No
Memory Retention	This field determines whether to allow the pager to retain all messages when it is turned off and back on. Otherwise, the pager clears out all messages and all related message information (including protected messages and notebooks).	Yes No
Delete All	This field determines whether all read, unprotected messages can be deleted. NOTE: This option does not apply to the following messages: unread messages, messages with alarms, messages with unacknowledged expired alarms, locked messages, or notebooks.	Yes No
14-Bit Decoding	This field determines whether to enable the pager's 14-bit languages including Traditional and Simplified Chinese. The 14-Bit method uses the low byte first and high byte second. The 2-byte method is the default (used when No is set) and is used when ideographic languages are not being programmed. The 2-byte method uses the high byte first and the low byte second. NOTE: Only displayed when pager is equipped with a CG-ROM.	No Yes
Ideo Numeric Canned Msgs.	This field specifies the type of ideo numeric canned messages to be used by the pager. NOTE: Only displayed when pager is equipped with a CG-ROM.	None 2-digit Extended
Regular Canned Msgs	This field determines whether to allow or disallow the pager to display canned messages. Preset messages have been programmed into a table within the CG-ROM. This option is used when you are programming the pager for ideographic characters. NOTE: Only displayed when pager is equipped with a CG-ROM.	Yes No
Canned Msgs Start Address	This field specifies the beginning memory address of canned messages in the CG-ROM. This option is used when programming a pager for ideographic languages. NOTE: Only displayed when pager is equipped with a CG-ROM.	Traditional Chinese 3321 HEX Simplified Chinese 7821 HEX
Canned Msgs End Address	This field specifies the ending memory address of canned messages in the CG-ROM. This option is used when programming a pager for ideographic languages. NOTE: Only displayed when pager is equipped with a CG-ROM.	Traditional Chinese 3F7E HEX Simplified Chinese 7D47 HEX

Field Name	Description	Value(s)
Message Preview	This field determines whether to Allow or disallow the pager to display the first line of all received, unread messages as a preview.	No Yes
Auto Backlight Disabled	This field defines whether auto backlight is disabled (Yes) or enabled (No). When disabled, the backlight does not automatically display when a pager key is pressed while in a dark condition. However, the backlight can be manually activated.	No Yes
Use Checksum For Errors	This field determines whether to use the message/fragment checksum to determine when code words are considered errored.	Yes No
Display Contrast Value	This field selects the display contrast on pagers.	0-15

Using Your PPS

More Features

This screen provides the second half of the custom selectable options available with the Product Family 56A (FLEX) pager.

UNIFICATION Pager Programming Software PRODUCT FAMILY 56A - ALPHA ELITE		Use Space Bar to select. PgUp & PgDn to other menu.
Main:MoreFeatures;		
Enable Battery Gauge		Yes
Battery Gauge Level - High	1.34v	
Battery Gauge Level - Med	1.29v	
Battery Gauge Level - Low	1.24v	
Manual Print		No
Automatic Print		No
Print Message Separator		No
Print CR With LF		No
Show Memory Full		Yes
Area Code Suffix		Space
Exchange Suffix		Dash
Zoom		Yes
Show Tone Only Source		1-8

F1	F2	F3	F4	F5	F6	F7	F8	F9	F10
HELP	PGM PAGER	CODE	PROMPT	ALERT	PASSWD OTA		FEATURES	SET TO DEFAULTS	EXIT

Function Key	Description
F2	Selecting this key programs this pager with the configuration you have selected.
F3	Select this key to display the Code screen. For more information about this screen, see "Code Options (Single)" on page 18 or "Code Options (Sequential)" on page 22.
F4	Select this key to display the Prompts screen. For more information about this screen, see "Prompts" on page 23.
F5	Select this key to display the Alert screen. For more information about this screen, see "Alert Screen" on page 28.
F6	Select this key to display the OTA Programming screen. For more information about this screen, see "Password/OTA Programming Options" on page 32.
F8	Select this key to display the Features screen. For more information about this screen, see "Features Options" on page 35.
F9	Select this key to reset all fields to their default values.
F10	Selecting this key returns the program to the Main menu. NOTE: You can also press Esc .

Field Name	Descriptions	Value(s)
Enable Battery Gauge	This field defines whether the battery gauge icon is displayed as the battery is used.	Yes No
Battery Gauge Level-High	This value represents the battery voltage level necessary for the battery gauge to display a high, medium, or low voltage level battery icon. If the battery voltage is higher than or equal to this value, the full battery gauge icon is displayed. The High level must be greater than the Med level, and the Med level must be higher than the Low level. None of the levels can be equal to each other.	1.63V, 1.58V, 1.53V, 1.48V, 1.43V, 1.39V, 1.34V, 1.29V, 1.24V, 1.19V, 1.14V, 1.09V, 1.05V, 1.00V, 0.95V, or 0.90V
Battery Gauge Level-Med	This field specifies the medium level voltage for the battery. When the battery reaches this voltage level, the medium level battery icon is displayed. The Med level must be higher than the Low level and lower than the High level. None of the levels can be equal to each other.	Use values listed for High level
Battery Gauge Level-Low	This field specifies the Low level voltage for the battery. When the battery reaches this voltage level, the low level battery icon is displayed. The Low level setting must be lower than both the medium and high settings. None of the levels can be equal to each other.	Use the values listed for High level
Manual Print	This field determines whether message printing is allowed using the pager's Function menu.	No Yes
Automatic Print	This field defines whether incoming messages can be automatically printed through the serial interface port.	No Yes
Print Message Separator	This field specifies whether the message separator character be inserted at the end of the text sent to the printer and before the source and time stamp. The ASCII ETX character is used.	No Yes
Print CR with LF	This field specifies whether single carriage returns or line feeds are converted to the two character combination CR/LF before being sent to the printer.	No Yes
Show Memory Full	This field determines whether the pager displays an icon and memory full prompt when the memory full condition is present. The pager's memory is considered full when all 19 personal message slots are occupied or when 5 or less free blocks of memory remain in the personal message list.	Yes No
Area Code Suffix	This field determines whether a dash or a space is displayed after the third digit in a ten digit formatted numeric message.	Dash Space
Exchange Suffix	This field determines whether a dash or a space is displayed after the sixth digit in a ten digit formatted numeric message, or after the third digit in a seven digit formatted numeric message.	Dash Space
Zoom	This field determines whether the pager can enlarge the characters in the display to two times their normal size. The four-line pager looks like a two-line pager, increasing message visibility.	No Yes

Using Your PPS

Field Name	Descriptions	Value(s)
Show Tone Only Source	This field determines whether the pager can display the source for a tone only page.	None 1-4 5-8 1-8

Program Menu

After you finish selecting the desired pager configuration, you are ready to program your pager.

UNICATION Pager Programming Software PRODUCT FAMILY 56A - ALPHA ELITE Main:Program : PROGRAM Menu	Select key F1 - F10. PgUp or PgDn to other menu.
F1 - HELP F2 F3 F4 - PROGRAM pager (Pager must be ON & inserted in interface box) F5 - SAVE CONFIG then PROGRAM pager F6 F7 - Return to previous menu F8 - Skip to next menu F9 F10 - EXIT to Main Menu	

F1	F2	F3	F4	F5	F6	F7	F8	F9	F10
HELP			PROGRAM	SAVE &		PREVIOUS	NEXT		EXIT
			PAGER	PROGRAM		MENU	MENU		TO MAIN

Function Key	Description
F4	Select this key to program the pager.
F5	Select this key to save the configuration file to the hard drive and then immediately program the pager. NOTE: Use this key to program sequential pagers when you need to save each configuration file in the sequence.
F7	Select this key to display the previous menu.
F8	Select this key to display the next menu.
F10	Selecting this key returns the program to the Main menu. NOTE: You can also press Esc .

Save Menu

This menu allows you to save the pager configuration to a disk for future use.

UNIFICATION Pager Programming Software PRODUCT FAMILY 56A - ALPHA ELITE		Select key F1 - F10. PgUp or PgDn to other menu.							
Main:Program: SAVE Menu									
F1 - HELP F2 F3 F4 - SAVE this pager configuration to disk F5 F6 F7 - Return to previous menu F8 - Skip to next menu F9 F10 - EXIT to Main Menu									
F1 HELP	F2	F3	F4 SAVE TO DISK	F5	F6	F7 PREVIOUS MENU	F8 NEXT MENU	F9	F10 EXIT TO MAIN

Function Key	Description
F4	Select this key to save the configuration file to the hard drive. The Save To CP screen is displayed. Type the file name in the File Name field. If you want to add a comment about this file, press Enter and type your comments. When you are finished, press F8 .
F7	Select this key to display the previous menu.
F8	Select this key to display the next menu.
F10	Selecting this key returns the program to the Main menu. NOTE: You can also press Esc .

Print Menu

This menu provides an option to print the current pager programming configuration.

UNICATION Pager Programming Software PRODUCT FAMILY 56A - ALPHA ELITE Main:Program: PRINT Menu	Select key F1 - F10. PgUp or PgDn to other Menu.
F1 - HELP F2 F3 F4 - PRINT pager configuration F5 F6 F7 - Return to previous menu F8 - Skip to next menu F9 F10 - EXIT to Main Menu	

F1	F2	F3	F4	F5	F6	F7	F8	F9	F10
HELP			PRINT CONFIG			PREVIOUS MENU	NEXT MENU		EXIT TO MAIN

Function Key	Description
F4	Select this key to print the pager configuration. NOTE: Your printer must be connected to either a serial port or a parallel printer port.
F7	Select this key to display the previous menu.
F8	Select this key to display the next menu.
F10	Selecting this key returns the program to the Main menu. NOTE: You can also press Esc .

Using Your PPS

Setup Menu

This menu provides choices for selecting the communications path and color configuration of the screens.

➔ Press **F9** from the Main menu to access this screen.

UNIFICATION Pager Programming Software PRODUCT FAMILY 56A - ALPHA ELITE					Select key F1 - F10				
Main:Setup;									
<p>F1 - HELP F2 F3 - Communication Setup F4 F5 F6 F7 - Color Configuration F8 F9 F10 - EXIT</p>									
F1 HELP	F2	F3 COMM	F4	F5	F6	F7 COLOR	F8	F9	F10 EXIT

Function Key	Description
F3	Select this key to display the Comm Setup options screen. For more information about this screen, see "Comm Setup Options" on page 47.
F7	Select this key to display the Color Options screen. NOTE: This option is not displayed if you are using a monochrome monitor.
F10	Selecting this key returns the program to the Main menu. NOTE: You can also press Esc .

Comm Setup Options

This screen allows you to set up your computer's configuration. You can select the disk drive and path name to which your configuration files are archived and the communications port used to communicate to the Programming Interface. This screen also provides a second chance (first chance is during the install process) to use password protection.

UNIFICATION Pager Programming Software PRODUCT FAMILY 56A - ALPHA ELITE		Enter Drive and Path (ex: C:)							
Main:Setup:Comm;									
Arch Path	C:\PF56AFLX\ARC								
SW Password	[REDACTED]								
Com Port	COM1:								
Bit Rate	4800								
Parity	None								
Data Bits	8								
Stop Bits	1								
Printer Port	PRN1:								
F1	F2	F3	F4	F5	F6	F7	F8	F9	F10
HELP							SAVE DEFAULTS		EXIT

Function Key	Description
F8	Select this key to save your selections. If you do not save this configuration, it will only be valid for the current session.
F10	Selecting this key returns the program to the Main menu. NOTE: You can also press Esc .

➔ *The parameters for a communications port to the pager are preset to: 4800 bit rate, no parity, 8 data bits, and 1 stop bit in Product Family 56A (FLEX) pagers. Make sure they are set correctly.*

Using Your PPS

Field Name	Description	Value(s)
Arch Path	This field defines the full path name of the directory in which the PPS stores the pager configuration files. Ordinarily, this parameter is initialized during execution of the setup program and does not need to be changed.	C:\PF56AFLXIARC (any directory path)
SW Password	A software password can be entered to prevent unauthorized use of this program. If no password is required, leave this field blank. If you used a password during Setup, this field uses it. If you did not use one during Setup, you can insert one now.	(blank)
Com Port	This field specifies the serial communication port the programming interface uses to communicate with the pager. Ensure the communications port selected is not used by another software application; some RAM-resident desktop organizers reserve a communications port for their own use. NOTE: <i>The program uses COM1 as the default communications port. If both a serial port and a modem are used on the computer, it is recommended that COM1 be used as the serial port. If COM1 cannot be used, change the default to COM2 in the computer configuration screen.</i>	COM1 COM2 COM3 (when available) COM4 (when available)
Bit Rate	This is the bit rate or speed at which the communications port sends data bits. Pressing the space bar toggles through the valid choices.	300 600 1200 2400 4800 9600 19200
Parity	This is the method used to check for parity or error.	None Even Odd
Data Bits	This field defines the number of data bits per byte. Pressing the space bar toggles between the choices.	8 7
Stop Bits	This field defines the number of stop bits to use. Pressing the space bar toggles between the choices.	1 2
Printer Port	Select the printer port used to connect the computer to the printer.	PRN1 PRN2

Color Options

This screen allows you to select the color of the screen, messages, outlines, and text on the program screens.

➔ Press **F7** from the Setup Menu to display this screen.

UNICATION Pager Programming Software PRODUCT FAMILY 56A - ALPHA ELITE Main:Setup:Color ;	Use ARROW keys to move, SPACE BAR to select.																		
<table> <tr><td>Text</td><td>Lite Green</td></tr> <tr><td>Status</td><td>Lite Green</td></tr> <tr><td>Heading</td><td>Lite Green</td></tr> <tr><td>Help</td><td>Lite Green</td></tr> <tr><td>Highlight</td><td>White</td></tr> <tr><td>Warning Message</td><td>White</td></tr> <tr><td>Screen Outline</td><td>Lite Green</td></tr> <tr><td>Background</td><td>Blue</td></tr> <tr><td>Popup Background</td><td>Brown</td></tr> </table>		Text	Lite Green	Status	Lite Green	Heading	Lite Green	Help	Lite Green	Highlight	White	Warning Message	White	Screen Outline	Lite Green	Background	Blue	Popup Background	Brown
Text	Lite Green																		
Status	Lite Green																		
Heading	Lite Green																		
Help	Lite Green																		
Highlight	White																		
Warning Message	White																		
Screen Outline	Lite Green																		
Background	Blue																		
Popup Background	Brown																		

F1	F2	F3	F4	F5	F6	F7	F8	F9	F10
HELP				SET TO DEFAULTS			SAVE SELECTIONS		EXIT

Function Key	Description
F5	Select this key to change all of the options to the default values.
F8	Select this key to save any changes you have made on this screen.
F10	Selecting this key returns the program to the Main menu. NOTE: You can also press Esc .

Technical Description

The Product Family 56A (FLEX) Pager Mechanical Interface is a passive interconnection between the NRN8815 Programming Interface and the Product Family 56A (FLEX) pager. The fixture has a receptacle (J1) that accepts the RJ-11 type plug of the coiled cable from the Programming Interface. Programming information is sent through the spring-loaded pins that make the appropriate contacts in the Product Family 56A (FLEX) pager.



Use only the Unication-supplied cable for connection between the Programming Interface and the Pager Mechanical Interface. Use of non-approved cables can result in improper operation and/or incorrect programming of the pager.

Programming information is sent to the Product Family 56A (FLEX) pager from the Programming Interface through the coiled cable. The operation of the Programming Interface is described in the Service Manual for the Programming Interface.

There are no active devices in the Product Family 56A (FLEX) Pager Mechanical Interface.

Maintenance Information

Keep the Pager Mechanical Interface spring-loaded contacts clean and make sure the RJ-11 plugs are properly seated in the receptacle on the Mechanical Interface and the Programming Interface.

The contacts can be cleaned with a soft, dry cloth. Do not use any solvents to clean the contacts or the outside of the interface. If necessary, a damp (not wet) cloth can be used to clean the outside of the interface. Do not immerse in water or other liquids.

In case of erratic operation, inspect the coiled cable between the Programming Interface and the Pager Mechanical Interface. If it appears to be damaged, or the contacts on the plug at either end appear weak or damaged, replace the cable.

Exploded View Diagram and Parts List

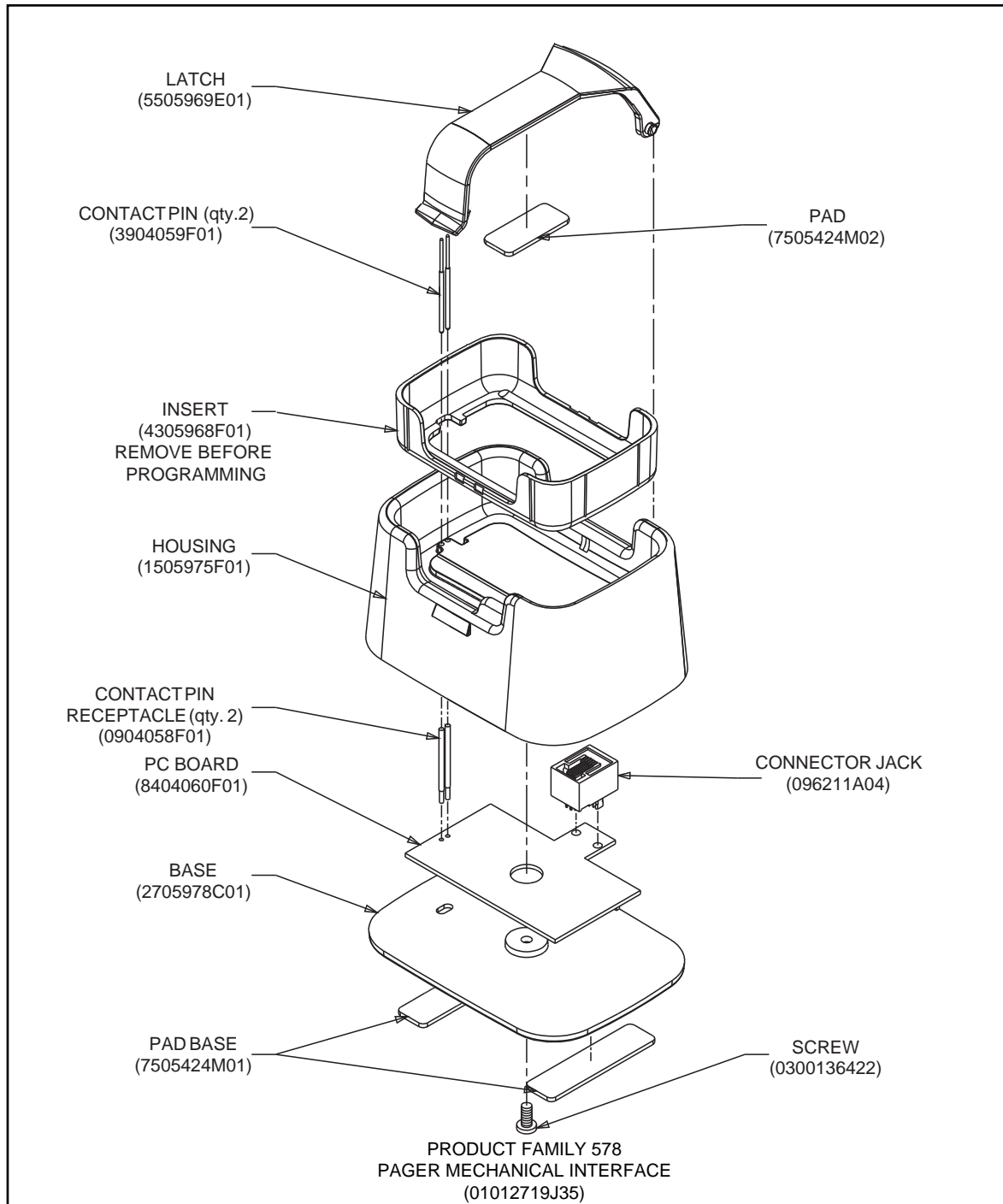

AIPB-93275-B

Figure 2. Pager Mechanical Interface

Troubleshooting Guide

Problem	Solution
Does Product Family 56A (FLEX) programming software run on COM3 or COM4?	It will run on these ports as long as no other device is connected to these ports.
When reading a pager, either the mouse no longer works or the communications to the pager can not be re-established.	This error often results from setting an asynchronous mouse to the same communications port interrupt used for the programming software. It is recommended that one of the communications ports be changed. Check that both devices are not set to even. Check that both devices are not set to odd. If either of these conditions exist, reset one device opposite of the other port.
The programming software reports a Data Communications error and never reads the pager.	Check the Programming Interface cable for correct installation. This is usually a 9- or 25-pin male connector on the back of the computer. Check that power supply cable is connected to a power source. Check that pager is in the OFF position and firmly seated in the Mechanical Interface, (red LED is illuminated). Check if there are any RAM-resident programs running.
The pager does not function after programming has been performed.	Check that capcode has not been changed. Check all functions. Ensure that entries have not been programmed to inactive status or incorrect. Check that Operating Mode was not programmed to Deaf .

Glossary

Archive File

This is a file which contains pager configuration information. This type of file is created using the Save Menu.

Default

A default is information automatically generated by the software program. Basically, any field that containing a pre-defined selection is called a default. Default information can be changed as necessary. It is used to ensure a basic entry is present for required information.

Field

This is an area on the screen in which you enter information.

Highlight Bar

The cursor is not represented by a single character space, but, instead, by a long bar.

Pager Clock Crystal

This is a crystal used inside the pager to control the time keeping function.

Sequential Programming

This refers to programming more than one pager.

Toggle

This means to sort through a list of selections.

Appendix - Prompts and Characters

This Appendix contains alphanumeric and ideographic translations and representations of the prompts displayed by the Product Family 56A pager. These can be used as a reference when checking the prompts on your pager.

Alphanumeric

The following tables provide a reference for the pager prompts when displayed in the languages supported by the Product Family 56A pager.

Table A-1. Portuguese, Spanish, and French Prompts

English	Americás Portuguese	Americás Spanish	French
SET TIME	AJUSTAR HORA	AJUSTAR HORA	REG. DE L' HEURE
SET ALARM	AJUSTAR ALARME	AJUSTAR ALARMA	REG. ALARME
TURN PAGER OFF	DESLIGAR BEEPER	APAGAR	ETEINDRE
ZOOM IN	ZOOM AMPLIACAO	ZOOM AMPLIADO	ZOOM APPROCH.
ZOOM OUT	ZOOM REDUCAO	ZOOM REDUCIDO	ZOOM ELOIGN.
ESCAPE	SAIR	SALIR	RETOUR MENU
DUPLICATE MESSAGE	MENSAGEM DUPLICADA	MENSAJE DUPLICADO	REPETITION
MOTOROLA	MOTOROLA	MOTOROLA	MOTOROLA
PAGER DISABLED	BEEPER DESATIVADO	BEEPER DESACTIVADO	HORS SERVICE
<1>	<1>	<1>	<1>
⋮	⋮	⋮	⋮
<16>	<16>	<16>	<16>
SET PRIVATE TIME	AJUSTAR TEMPO PRIV	AJUSTAR HORA PRIV.	REG. HORAIRE PRIVE
CHOOSE ALERT	ESCOLHER ALERTA	ESCOGER ALERTA	CHOIX TYPE DE SIGNAL
SET AUDIBLE ALERT	ALERTA SONORO	ALERTA AUDIBLE	MODE SON.
SET SILENT ALERT	ALERTA SILENCIOSO	ALERTA SILENCIOSA	MODE SILENCIEUX
LOCK MESSAGE	BLOQUEAR MENSAGEM	BLOQUEAR MENSAJE	SAUVEGARD MESSAGE
UNLOCK MESSAGE	DESBLOQ MENSAGEM	DESBLOQUEAR MENSAJE	ANNULER SAUVEGARDE
DELETE MESSAGE	APAGAR MENSAGEM	BORRAR MENSAJE	EFFACER CE MESSAGE
DELETE ALL MESSAGES	APAGAR TODAS MENSAG	BORRAR TODOS MENS	TOUT EFFACER
MEMORY FULL	MEMORIA CHEIA	MEMORIA LLENA	MEMOIRE SATUREE
STANDARD ALERT	PADRAO	ESTANDARD	BIP STANDARD
PLEASING ALERT	ALERTA MUSICAL	AGRADABLE	SIGNAL MUSICAL
CHIRP ALERT	ALERTA SIMPLES	CHIRRIDO	SIGNAL "BIP SIMPLE"
CHIRP & SILENT	ALERTA MUSIC SILENC	ALERTA CHIRR/SILENC.	ALARME SIL SON
NO MESSAGE ALERT	SEM ALERTA	SIN ALERTA	PAS DE SIGNAL SONORE
MAILDROP ALERT ON	ALERTA INFO ATIVADO	ALERTA BUZON ACTIV.	MESS.COURRIER ACT.
MAILDROP ALERT OFF	ALERTA INFO DESATIV	ALERTA BUZON DESACT.	MESS.COURRIER INACT.

Appendix - Prompts and Characters

Table A-1. Portuguese, Spanish, and French Prompts (Continued)

English	Americás Portuguese	Americás Spanish	French
ON	LIGADO	PRENDER	MARCHE
OFF	DESLIGADO	APAGAR	ARRET
ADD TO NOTEBOOK	MOVER PARA PESSOAL	AGREGAR A LIBRETA	AJOUT.A ESPACE PERSO
SET MESSAGE ALARM	AJ ALARME DA MENS	AJUSTAR ALARMA MENS	RAPPEL SUR MESSAGE
NOTEBOOK	ARQUIVO PESSOAL	LIBRETA	ESPACE PERSONNEL
TONE ONLY	SO TOM	SOLO TONO	BIB SEUL
GROUP	MENSAGEM GRUPO	MENSAJE DE GRUPO	"GROUPE"
PRINT	IMPRIMIR	IMPRIMIR	IMPRIMER
SET TIME AND ALARM	AJUSTAR HORA/ALARME	AJUSTAR ALARMA/HORA	REGL.HEURE ET ALARME
VOICE MAIL	CORREIO DE VOZ	CORREO DE VOZ	COURRIER VOC.ELECTR.
EMAIL	CORREIO ELETR.	E-MAIL	COURRIER ELECTR.
FAX	FAX	FAX	FAX

Ideographic

The following tables provide a reference for the pager prompts when displayed in the Simplified and Traditional Chinese languages supported by the Product Family 56A pager.

Table A-2. Product Family 56A Chinese Prompts

English	Traditional Chinese	Simplified Chinese
SET TIME	調整時間	调整时间
SET ALARM	調整鬧鐘	调整闹钟
TURN PAGER OFF	關機	关机
SET TIME AND ALARM	調時間鬧鐘	调时间闹钟
DUPLICATE MESSAGE	重複信息	重复信息
MOTOROLA	摩托羅拉公司	摩托罗拉公司
PAGER DISABLED	鎖機	锁机
SOURCE <1>	來源 1	来源 1
⋮		
SOURCE <16>	來源 16	来源 16
CHOOSE ALERT	鳥鳴警示	选警示方式
SET AUDIBLE ALERT	有聲警示	选有声警示

Appendix - Prompts and Characters

Table A-2. Product Family 56A Chinese Prompts (Continued)

English	Traditional Chinese	Simplified Chinese
SET SILENT ALERT	無聲警示	选无声警示
LOCK MESSAGE	信息鎖定	信息锁定
UNLOCK MESSAGE	信息解鎖	信息解锁
DELETE MESSAGE	刪除信息	删除信息
DELETE ALL MESSAGES	刪全部信息	删全部信息
MEMORY FULL	存儲已滿	内存已满
STANDARD ALERT	標準警示	标准警示
TONE ONLY	單音訊息	单音呼叫
PLEASING ALERT	悅耳警示	悦耳警示
NO MESSAGE ALERT	無信息警示	无信息警示
ON	開機	开机
OFF	關機	关机
ADD TO NOTEBOOK	存入記事簿	存入记事
SET MESSAGE ALARM	設信息鬧鐘	设信息闹钟

Table A-2. Product Family 56A Chinese Prompts (Continued)

English	Traditional Chinese	Simplified Chinese
ESCAPE	退回原狀態	退回原状态
GROUP	群呼	群呼
NOTEBOOK	記事簿	记事本

Table A-2. Product Family 56A Chinese Prompts (Continued)

	Traditional Chinese	Simplified Chinese
Voice Mail	語音信件	语音信件
Chirp & Silent Alert	鳥鳴與振動警示	鸟鸣与振动警示
Maildrop Alert On	開郵箱警示	开信箱警示
Maildrop Alert Off	關郵箱警示	关信箱警示
Chirp Alert	鳥鳴警示	鸟鸣警示
Zoom in	放大	放大
Zoom out	縮小	缩小
Print	列印	打印
Set Private Time	設定無聲時段	设定无声时段
FAX	傳真	传真
Email	電子信件	电子信件

Appendix - Prompts and Characters
